

Your guide to Boola Katitjin Learning Spaces

Discover spaces for teaching and learning, networking and connecting within Building 360 – Boola Katitjin

Introduction to Learning Spaces

Understanding how to effectively use space plays a significant role in teaching and learning, enabling both students and educators to construct meaning through their interactions with the content, and with one another, within such environments.

Boola Katitjin provides 21 formal Learning Spaces that can be requested for timetabled teaching, as well as many other spaces for events or ad-hoc bookings. Informal learning spaces, such as the 14 Project Rooms, are available for students to gather and collaboratively work on tasks. 8 Meeting Rooms for staff provide spaces for meetings and collaboration, while 6 Focus Rooms are setup for staff to record presentations or delivering virtual classes.

These spaces have been designed to put students at the centre of a social learning environment, enable innovative teaching methods with technology-enhanced features and aesthetic furnishings that encourage active and collaborative learning.

Together, we embrace the pedagogical and technology affordances that the new building provides, to deliver memorable and impactful learning experiences for our students.

In this guide, you will find detailed information for each learning space, including technology and room specifications, and further information on the affordances of the space design.



1

Learning Spaces in Boola Katitjin



Level 1

Level 1 welcomes students, staff and visitors to Murdoch as they enter from Discovery Way.

On entering, you will be greeted with a warm welcome, and will experience an environment featuring double-height ceilings, soundscapes and digital artwork.

To your right, the Welcome Space will be bustling with activity and the scent of fresh coffee from the espresso bar.

You can take a lift, stairs or escalator to Levels 2, 3 & 4, or stroll the Promenade.

The undercover Promenade connects you to The Broadwalk and Bush Court, while other walkways flow up through the landscape, across Banksia Court, and provide access to surrounding buildings.

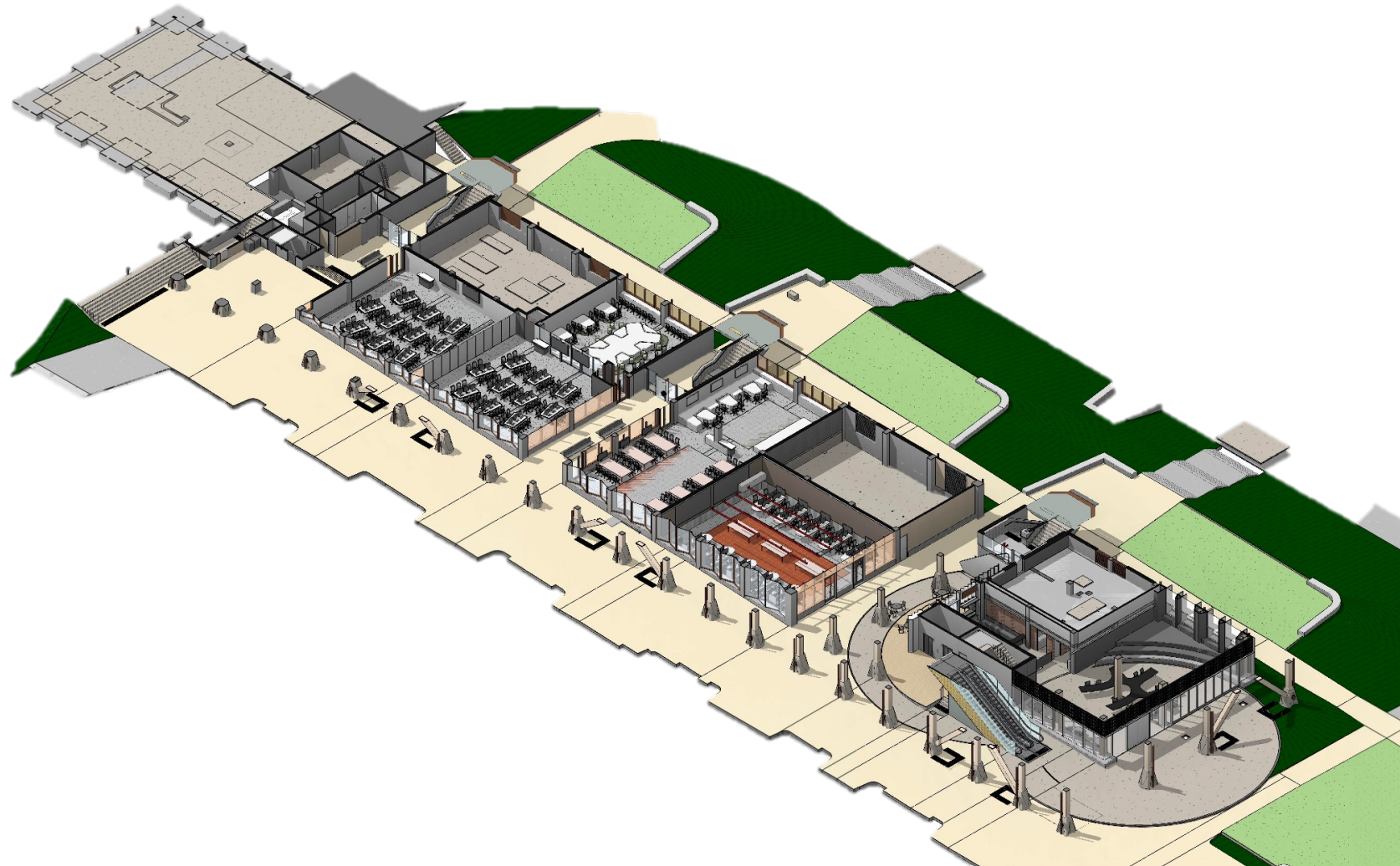

Welcome Space

On entering Boola Katitjin, visitors, students and staff are greeted by the arrival hall, with its open façade, espresso bar and immersive digital art ribbon. It is a space that facilitates transition, meeting and short-stays.

The digital touch-panel provide wayfinding information.

Adjacent is the **Welcome Space**, featuring tiered seating that is suited and equipped for seminars, panel events and presentations.

With its grand double height space, contemporary lighting design and the unique architecture of Boola Katitjin, the Welcome Space is an ideal location for a showcase event.

AUDIO-VISUAL

The Welcome Space is suitable for events requiring audio-visual technology.

A Podium is available to move into the space and provides similar AV controls that are found in formal learning spaces. Any of the 18 screens on the Digital Ribbon can be selected to deliver your presentation, providing flexibility in the configuration of your event. You can bring your own device to deliver audio and visual presentations.

CAPACITY

220 PEOPLE (COCKTAIL MODE with overflow outside)

70 PEOPLE (TIERED SEATING)

AVAILABILITY

The Welcome Space can be booked for events via Resource Booker.



View from front door into double height volume



Student mode

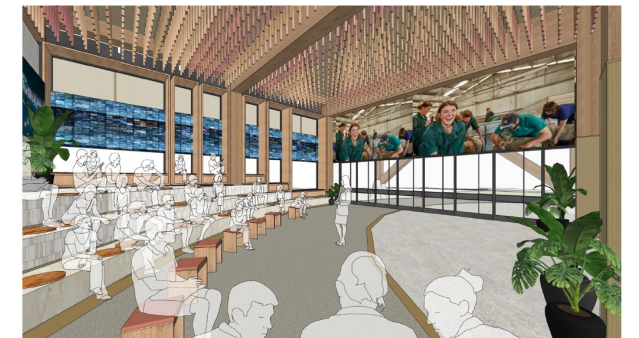

Seminar mode

For illustrative purposes only. Actual design, layout and colour scheme will be different in the final construction.

Digital Immersive Lab

The Digital Immersive Lab allows you to experiment with the future of learning experiences, by immersing students in virtual and mixed reality environments.

The space supports activities where students can explore large data sets, experiment with machine learning and build artificial intelligence capabilities, thanks to high performance computers with the power for intensive data processing.

Students will immerse themselves into virtual reality environments, where they can develop deeper understanding of complex topics and practices in a real-world simulation. Disciplines with laboratory or clinical work, virtual crime scene investigations or tourism destinations are just some suited to working in this space.

CAPACITY

1 VENUE
40 PEOPLE

AVAILABILITY

Available for timetabled classes and ad-hoc bookings via Resource Booker.

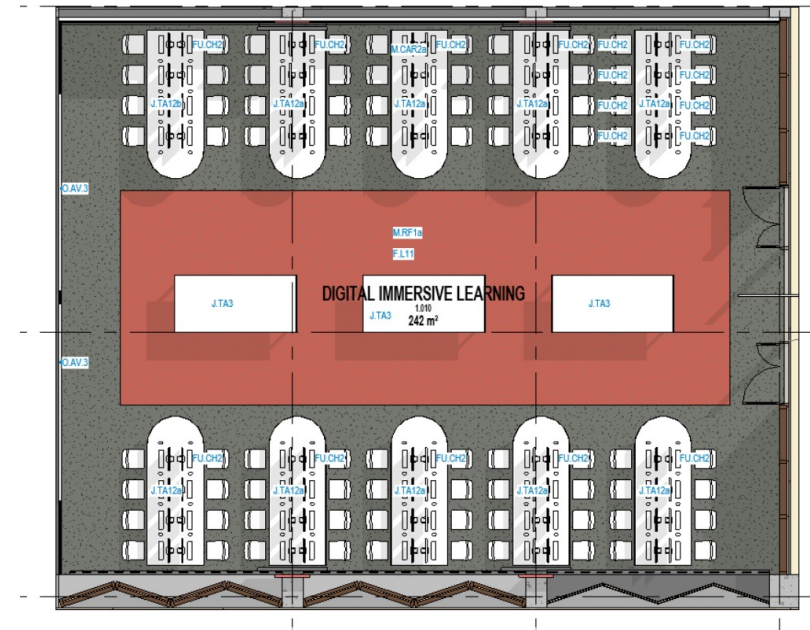

For illustrative purposes only. Actual design, layout and colour scheme will be different in the final construction.

Digital Immersive Lab Technology

The Digital Immersive Lab is equipped with technology to support digitally intensive learning experiences, such as simulations, virtual reality, augmented reality and gaming.

The Lab features 40 high powered Alienware computers with 4K resolution Dual LCD Screens on each desk. A screen mounted on the wall enables students to view media projected from the Podium. An 18-display video wall provides the Facilitator with large-scale display options. Lockable cabinets accessible via swipe card allow for secure equipment storage.

LEARNING ACTIVITIES

This space has been designed and equipped in consultation with Murdoch Academic staff members, and can support learning activities such as:

- Simulated hospital scenarios with holographic patients
- Explore cell biology
- Render 3D graphics for a computer game
- Develop a VR experience
- Explore high resolution maps for spatial analysis
- Perform large data computations

WEARABLE CAPABILITIES

Microsoft HoloLens 2

The Microsoft HoloLens 2 is a *mixed reality* (MR) wearable that allows the wearer to see and interact with digital elements as if they were real objects, while seeing and interacting with the real world.

The HoloLens 2 can be used to:

- Preview at-scale engineering and construction models,
- Visualise complex data with holograms,
- Include mixed reality information while undertaking a surgical procedure,
- Guide complex assembly and maintenance processes.

HTC Vive Focus 3

The HTC Vive Focus 3 is a *virtual reality* (VR) wearable that provides a full immersive digital experience by blocking out the real world and replacing it with a virtual environment.

Experiences can include virtual tourism, visualizing 3D models and concepts, or undertaking a workplace simulation such as a virtual healthcare environment. The devices feature 5K resolution for a sharp viewing experience and immersive 3D spatial sound, with precision hand gestures to provide a truly immersive experience.

TECHNICAL SPECIFICATIONS

Desktop: Alienware Aurora R13

- 12Gen Intel Core i9-12900KF with 30MB Cache and 3.2GHz-5.2GHz with Turbo Boost Max
- 750W Power Supply Unit with Liquid Cooling
- 128GB Dual Channel DDR5 RAM at 3600MHz
- 2TB NVMe SSD plus 2TB SATA Hard Disk
- NVIDIA GeForce RTX 3090 24GB GDDR6X
- Wireless and Bluetooth Capability
- Wired Keyboard and Mouse

Wearables

- 12 x Microsoft HoloLens 2
- 21 HTC Vive Focus 3

Specialised Software

- Alienware Command Centre
- Epic and Steam (Games Lib)
- Unity Hub
- Vive Business Streaming
- Microsoft HoloLens
- SideQuest for Oculus Quest
- Visual Studio

Creative Workshop

The Creative Workshop Space is positioned beside the Digital Immersive Learning space and available for ad-hoc bookings, including school and industry engagement events.

The Creative Workshop is a highly flexible use space designed for a variety of uses, such as pitch events, workshops, lunch and learn, events and focused work.

Intended for industry engagements, student innovation and school presentations, both facilitators and participants can bring devices and connect using wireless technology to the computer screens fitted on the collaboration booths and the group work desks.

AUDIO-VISUAL

A facilitator bench with a PC is positioned in the centre of the room, allowing flexibility for delivery. All screens have audio and AirMedia to enable Facilitators and workshop participants to display content from their own device.

CAPACITY

1 VENUE
56 PEOPLE + BOOTH SEATING

AVAILABILITY

Available for ad-hoc bookings via Resource Booker

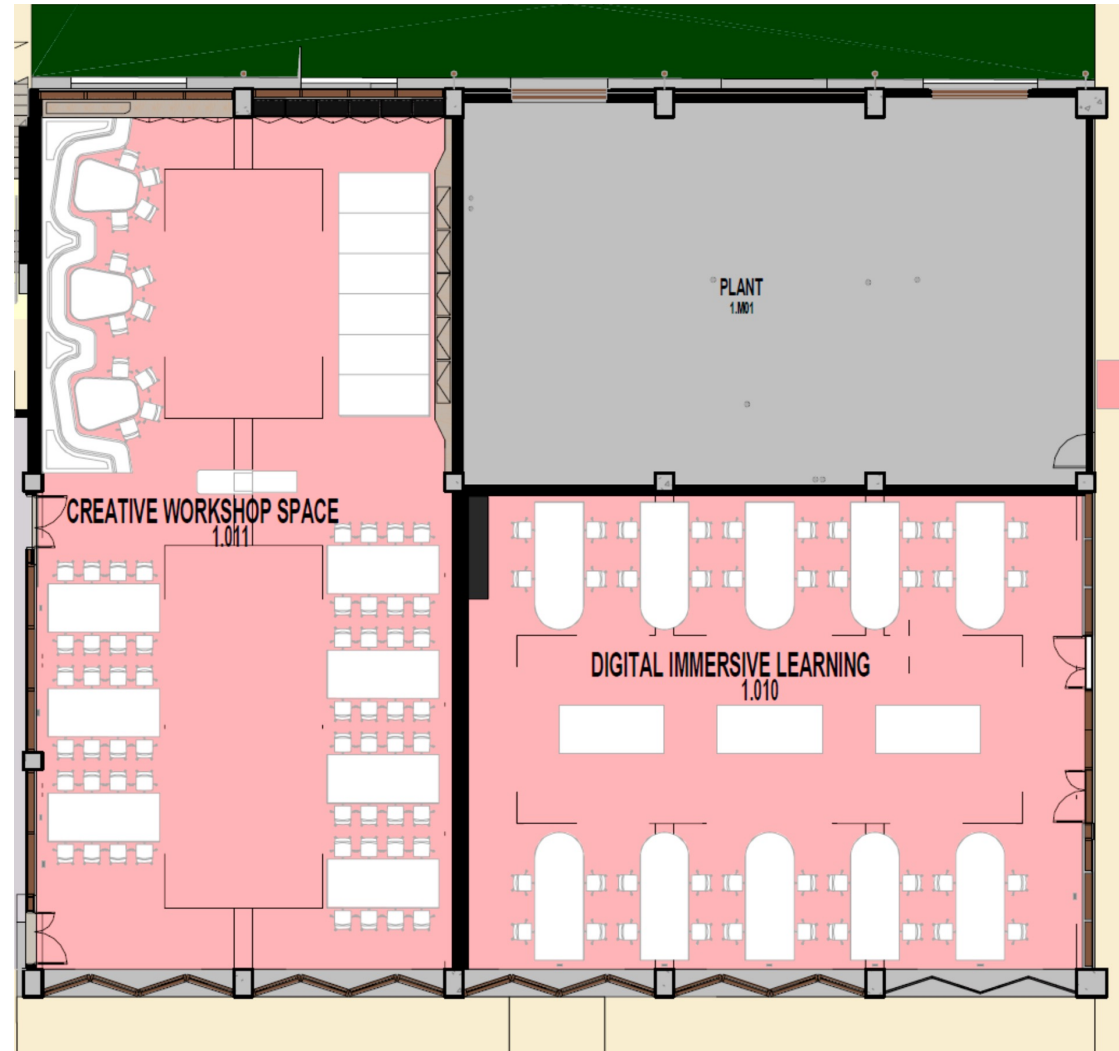

Creative Workshop Delivery Modes

PITCH / WORKSHOP MODE

In Pitch / Workshop mode, the Creative Workshop can be split into two spaces through furniture relocations.

The *intimate presentation space* has a stage with two screens, rear row fixed seating, and loose seating in the front.

The *breakout to create space* features movable desks with no fixed technology, making them suitable for making, creating and testing. Presenters can set up their pitch before going on stage.

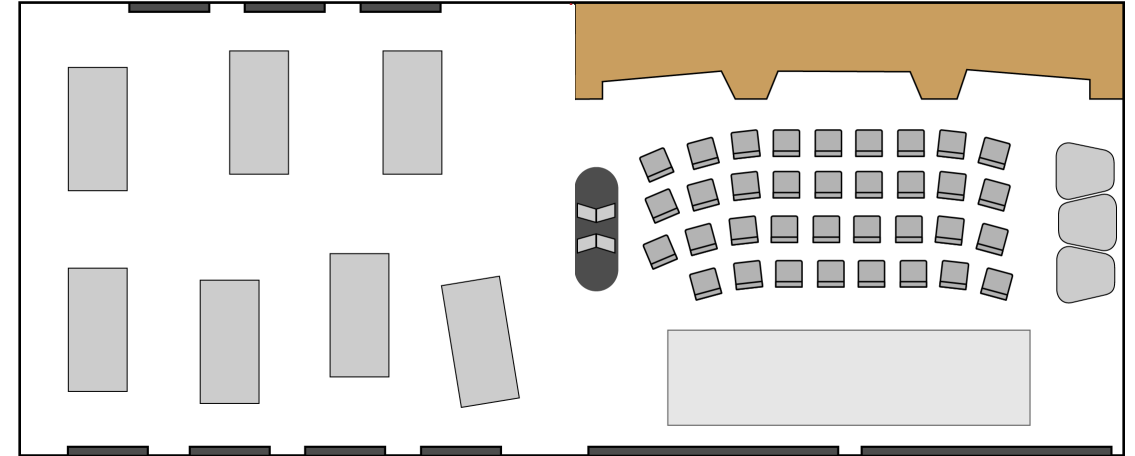

LUNCHTIME TALK

In Lunchtime Talk mode, the room is configured to suit presentations alongside a morning tea.

The *intimate presentation space* is configured with rear row fixed seating and loose seating in front, and the flexible tables have been set up for catering.

The *breakout to create space* has the tables folded and off to the side, creating a welcoming cocktail space for post-event mingling and conversation.

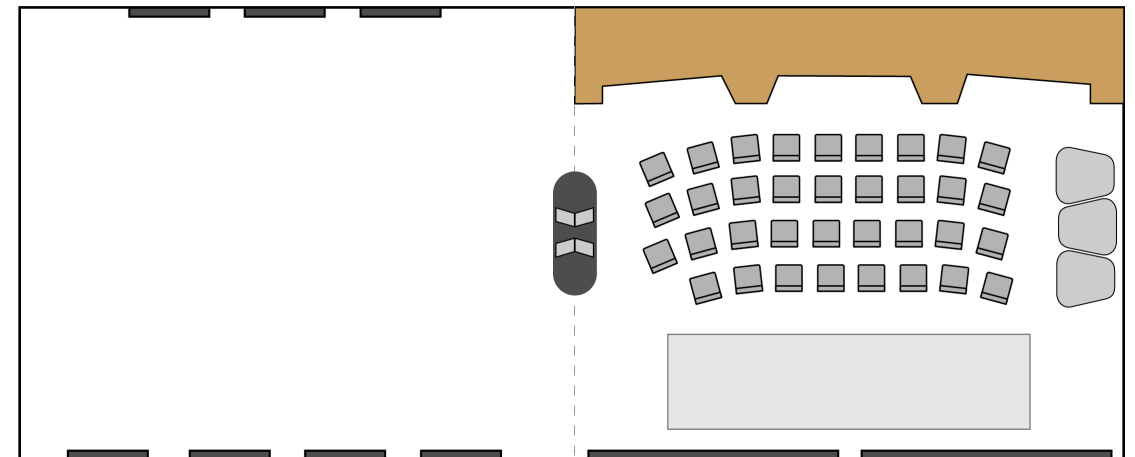

Creative Workshop Delivery Modes

SHOWCASE EVENT MODE

In Showcase Event mode, tables and loose chairs are packed away.

This creates a large open space suitable for showcase content or welcome speeches on the double Stage screens.

You can also present on the seven screens located around the *breakout to create* space, which could be suitable for digital art, multimedia exhibitions or research showcases.

Flexible tables are set up for catering.

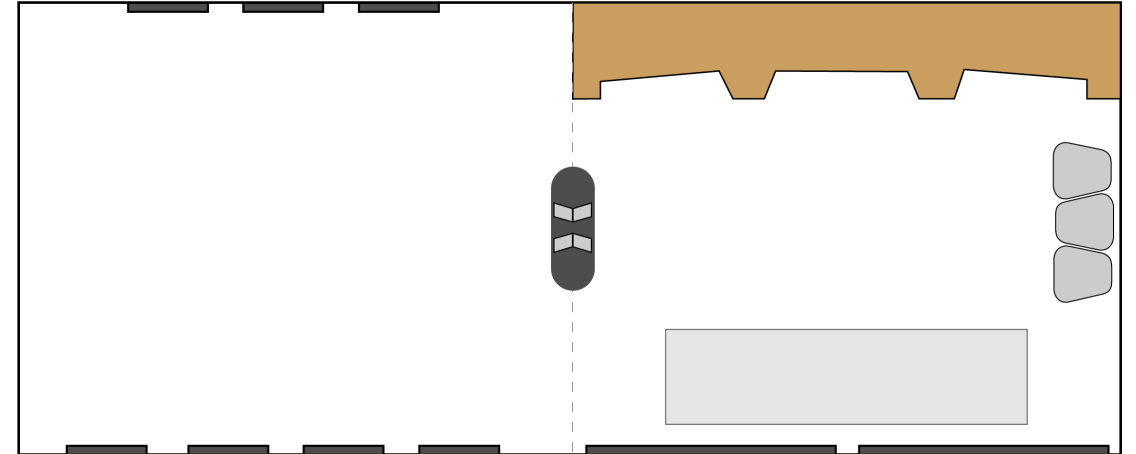

FOCUSED MODE

In Focused Mode, tables have been set up as group work desks in front of each *breakout to create* screen.

The central Facilitator Bench aids management of audio-visual controls and enables a facilitator to display content on the desk screens.

The presentation space has been configured with flexible tables and chairs, providing additional seating or breakout work.

This configuration is suitable as a coworking / incubator space.

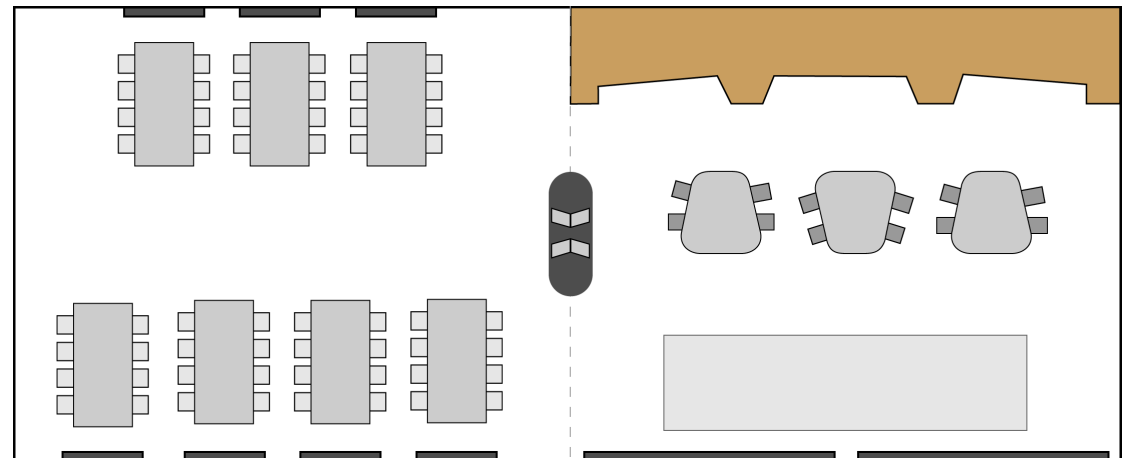

Computer Lab

Two 60-person computer labs, that can be combined as one large 120-person lab, are fitted with Dell All-In-One PCs that will suit a wide range of uses including information technology, graphic design, media, math, statistics, and geospatial data, amongst others.

When not timetabled, students will be able to use this space for self-directed learning. Large format multi-panel displays are present in each of the computer labs with input connections to the Podium.

CAPACITY

2 VENUES
60 PEOPLE (EACH)

These spaces can be connected to support one 120-person learning space.

AVAILABILITY

Available for timetabled classes and ad-hoc bookings via Resource Booker.

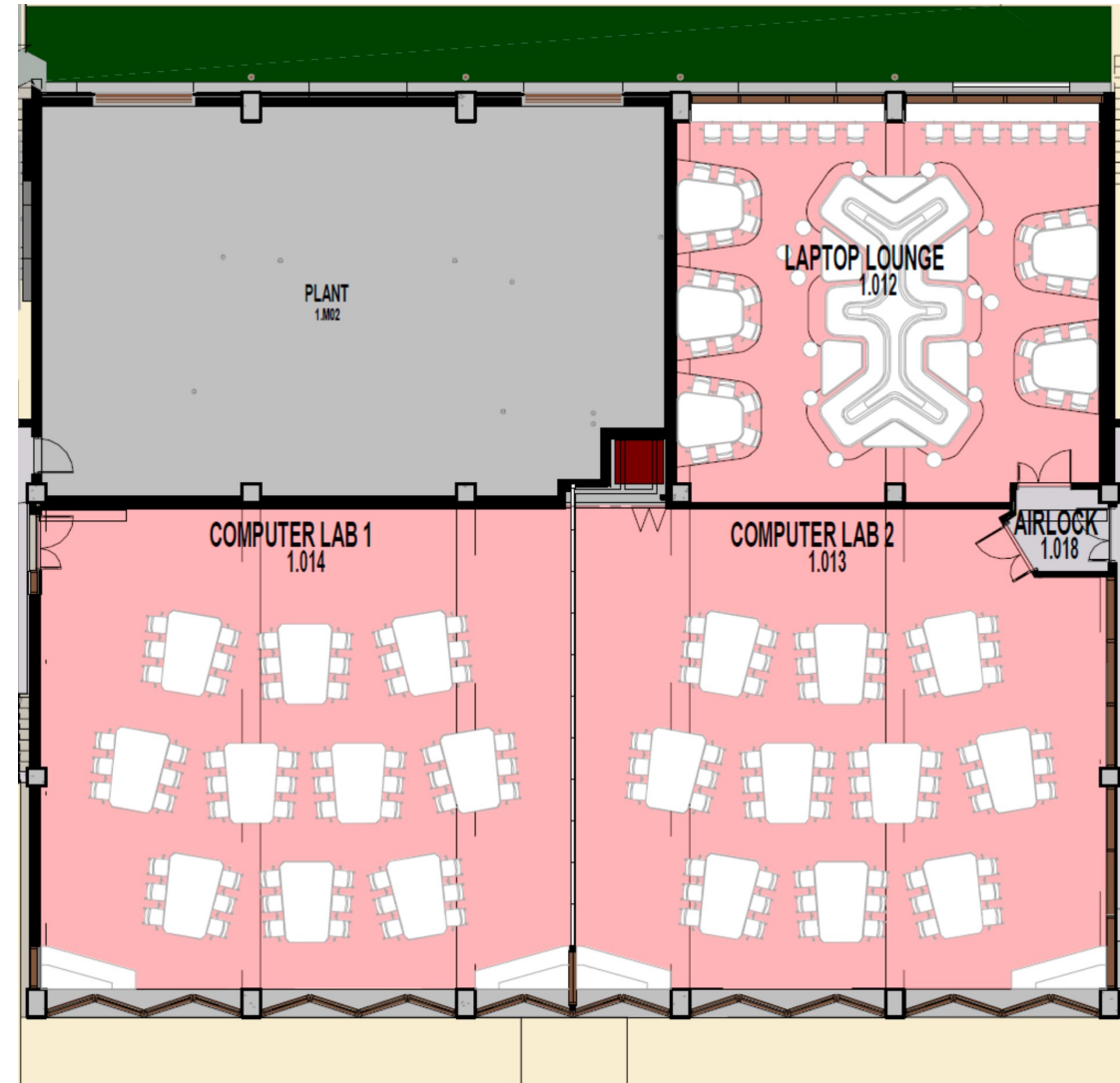

Computer Lab Technology

The Computer Labs are equipped with Dell All-In-One (AIO) PCs designed for a wide variety of computing uses.

LEARNING ACTIVITIES

Some of the learning activities that would suit this space include:

- Analyse statistical data sets
- Write computer programs
- Design web media
- Work on documents, independently or collaboratively
- Access, read and annotate environmental report

Students will be able to access Microsoft Teams, Microsoft OneDrive and other applications for collaborative written activities.

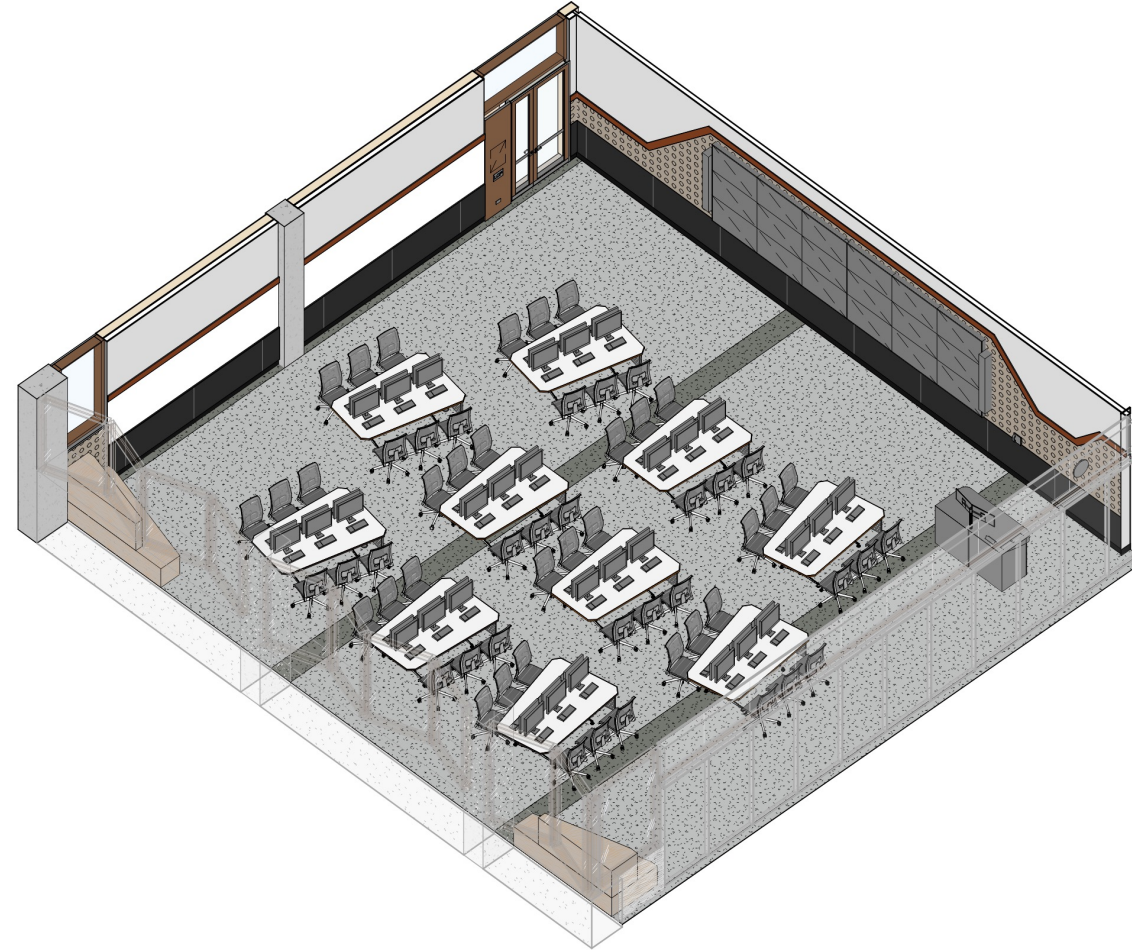

TECHNICAL SPECIFICATIONS

Desktop: Optiplex 7400 All-In-One

- All-In-One 23.8" Monitor
- 64 Watt CPU
- Intel Core i5-12500
- 16GB DDR4 RAM
- 256GB SSD
- Integrated Graphics Card
- Internal Speaker
- Height Adjustable Stand
- Wired Keyboard and Mouse
- No Wireless Card
- No Camera or Microphone
- USB Ports

Software

In addition to Microsoft Windows 11, Microsoft Office and the Murdoch standard operating environment.

If the software you need for teaching is not listed, please submit a request to IT via Service Now.

Level 2

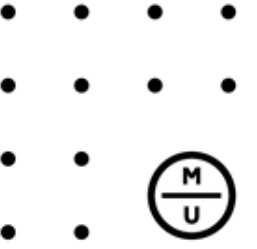

As you arrive at Level 2, you will be in the hive of productivity.

Collaborative and technology-enhanced learning spaces are complemented by the student hall, student portals with group-work desks, and project rooms being used by both staff and students.

The northern end features a pop-up retail space and seating on the deck looking out towards Banksia Court and the Library.

At the southern end is the flexible staff workplace. All staff members are welcome here to grab a desk to work for the day, use private meeting rooms, or produce a recording in the focus room.

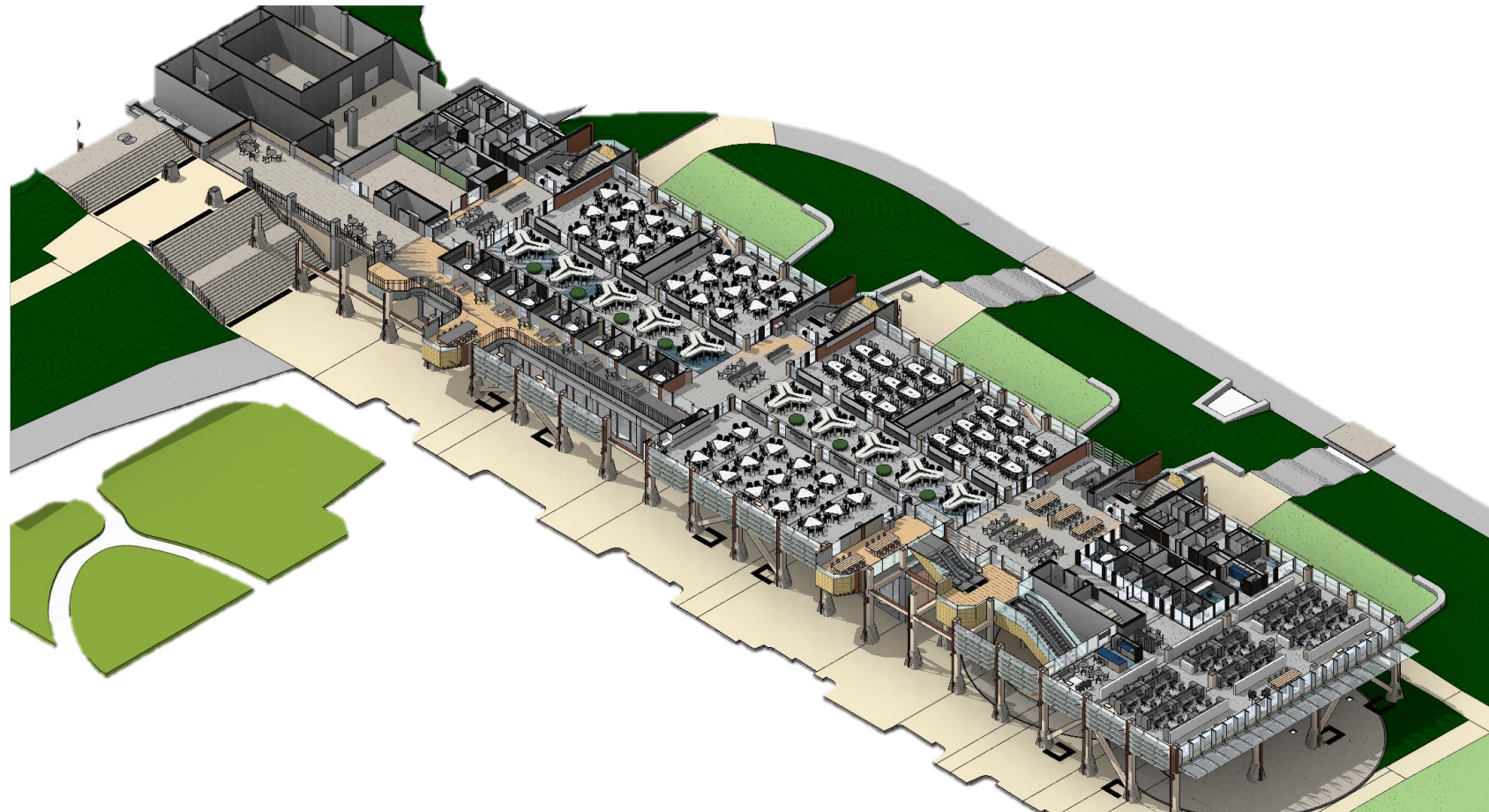

Technology-Enhanced Learning (TEL)

Equipped with the latest in audio-visual and virtual collaboration tools, the Technology-Enabled Learning (TEL) spaces offer opportunities to *enhance* learning by connecting physical and virtual participants in active engagement.

The features in these spaces also support the creation of learning environments that bring your remote students into the classroom to participate in learning activities and collaborate with their in-person peers.

The TEL desk spaces allow for individual and group learning activities to be easily shared across screens, while embedded microphones and tracking cameras facilitate ease of access for all learners, whether they are contributing from the physical or virtual classroom environment.

CAPACITY

2 VENUES
60 PEOPLE (EACH)

AVAILABILITY

Available for timetabled classes and ad-hoc bookings via Resource Booker

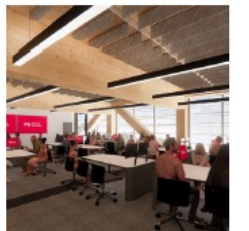
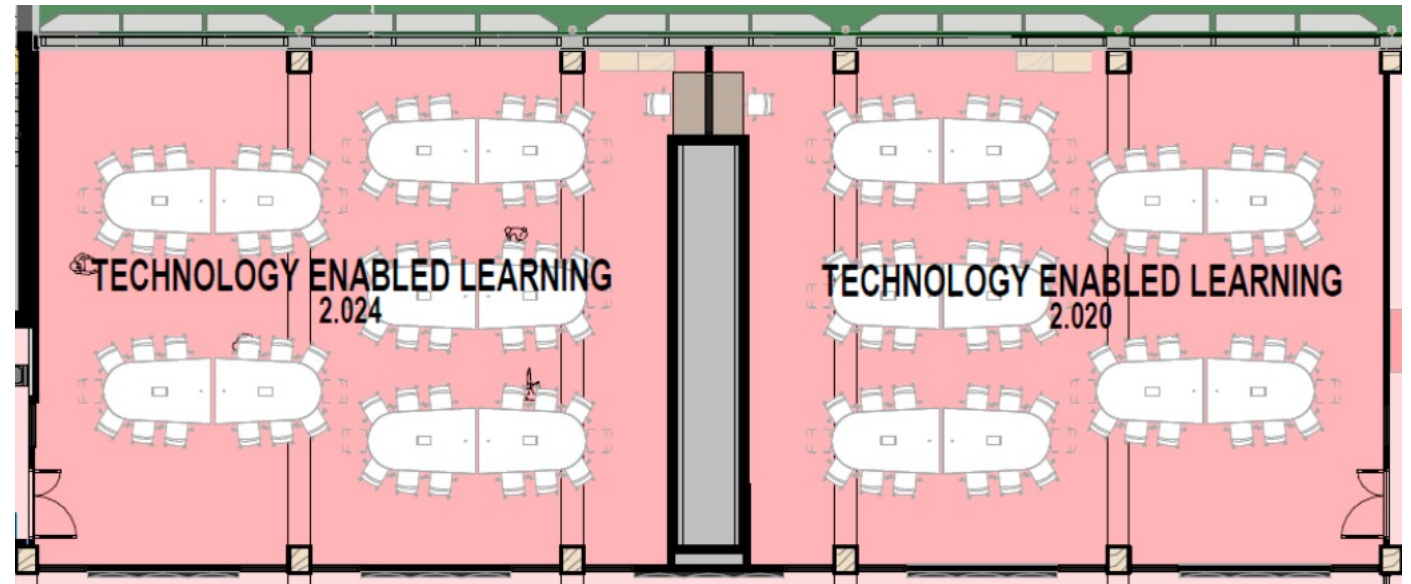

Scan for a 3D walk-through of a Technology-Enhanced Learning Space on Level 2 and Level 3

Collaborative Learning

Collaborative Learning spaces offer flexibility, with movable furniture that enables you to easily transition learners from independent to small or even large group learning activities.

Collaborative Learning spaces feature multiple large whiteboards and digital displays that allow for you and your students to mirror screens, share workings on the whiteboards, and engage in a variety of presentation opportunities.

CAPACITY

**2 VENUES
60 PEOPLE (EACH)**

**1 VENUE
90 PEOPLE (EACH)**

AVAILABILITY

Available for timetabled classes and ad-hoc bookings via Resource Booker.

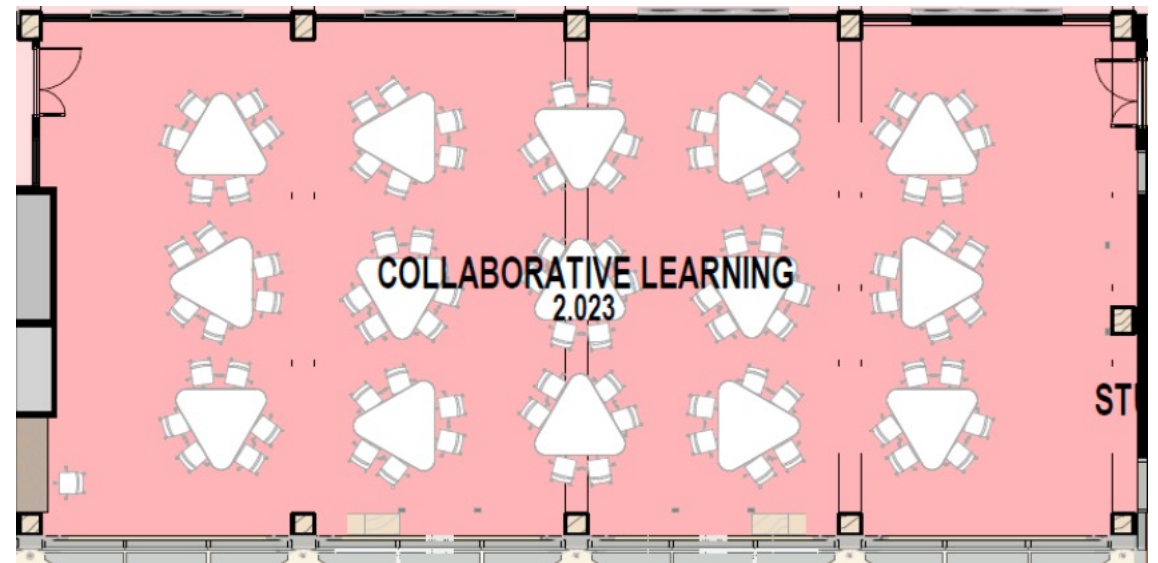
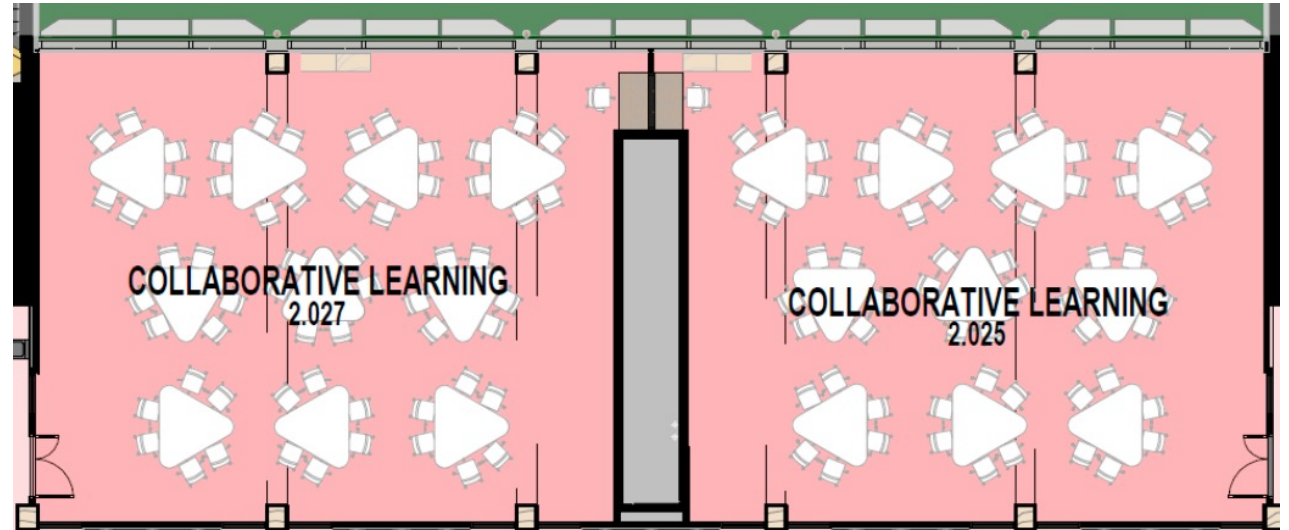

Level 3

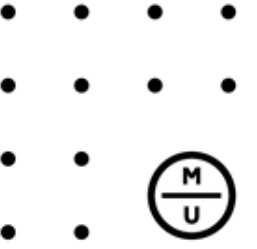

Level 3 connects Boola Katitjin to the Broadwalk and Bush Court and features the spectacular Northern Plaza. The expansive deck offers outdoor spaces for rest and relaxation, or to enjoy a meal from the café.

Student Central is located at the northern end, and as you walk through to the Student Hall you will find the Student Portal and external deck areas with a variety of seating options to support independent study, group work, and networking. A Digital touch-panel guides provide wayfinding information.

At the southern end is the flexible staff workplace, where any staff member can grab a desk to work between classes, recharge and refresh with the kitchen amenities, or use private meeting rooms.

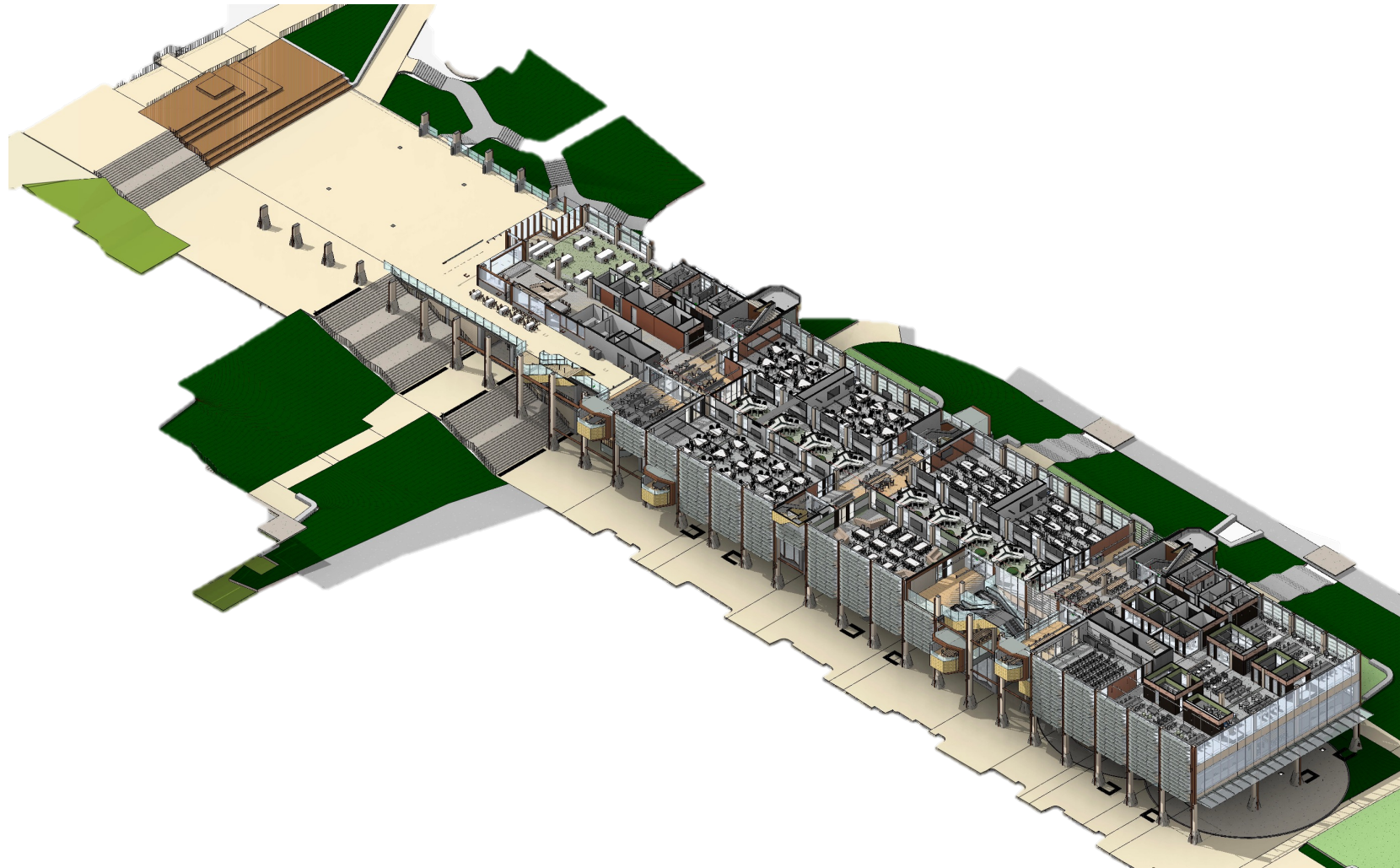

Northern Plaza

The Northern Plaza showcases the spectacular timber construction of Boola Katitjin, and will be the hub of activity as students, staff and visitors connect through to Bush Court, the Library, Student Hub and across the campus.

Of commanding size, approximately 70% of the 1000m² is undercover, accommodating up to 500 people depending on configuration. A large tree-shaded deck seating area at the north connects the Plaza to the Broadwalk.

Event provisions also available in this space, including three phase power, and a large format LED display with speakers facilitates information presentation. The area is also well-lit at night.

The Northern Plaza is suited to events that engage students and take in the bustle of the area, such as a career fair or market day, and can be booked for evening events.

CAPACITY

1 VENUE
500 PEOPLE

AVAILABILITY

Available for events and functions via Resource Booker.



Collaborative Learning

Collaborative Learning spaces offer flexibility, with movable furniture that enables you to easily transition learners from independent to small or even large group learning activities.

Collaborative Learning spaces feature multiple large whiteboards and digital displays that allow for you and your students to mirror screens, share workings on the whiteboards, and engage in a variety of presentation opportunities.

CAPACITY

**2 VENUES
60 PEOPLE (EACH)**

**1 VENUE
90 PEOPLE (EACH)**

AVAILABILITY

Available for timetabled classes and ad-hoc bookings via Resource Booker.

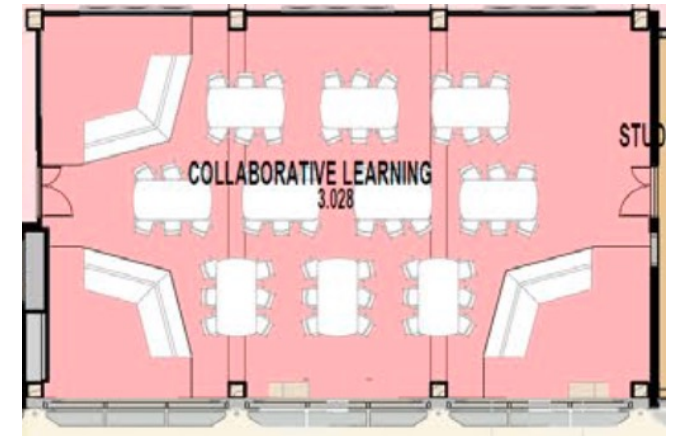
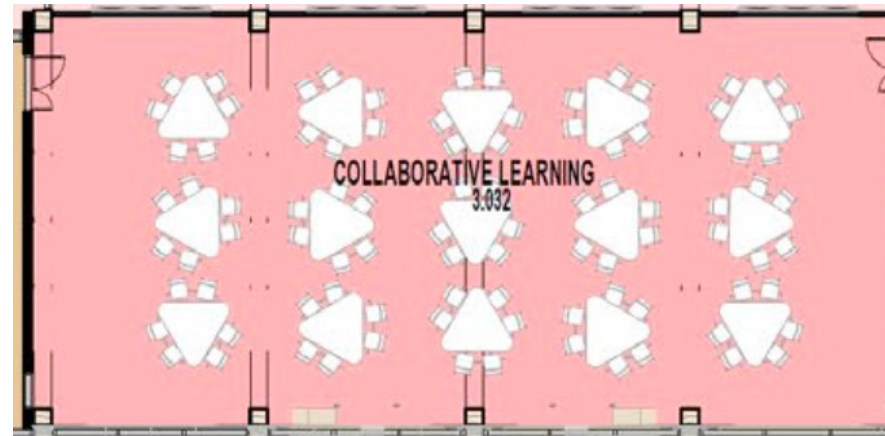
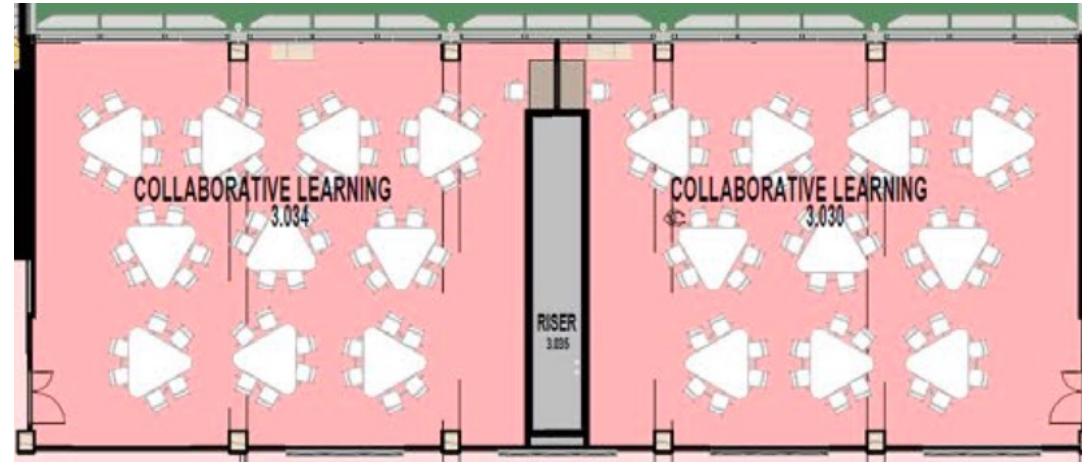

Collaborative Learning with Breakout

Collaborative Learning with Breakout

On Level 3, one of the Collaborative Learning spaces features design elements enabling you to experiment with collaborative learning experiences.

With 60-seat capacity and furniture that can be rearranged as needed, it features additional *corner display pods* to support interactive breakout group work.

These breakout corners feature lounges facing a screen that students can connect to wirelessly from their own device. This enables group participants to move aside from the main seating, work together on a problem, and return to the class to share their findings.

As a timetabled space, classes requesting a Collaborative Learning space will have been allocated to this classroom. When not scheduled for a timetabled class, ad-hoc bookings can be made.

Should you specifically like to teach in this classroom, contact the Timetabling team. It can also be booked outside of timetabled classes for ad-hoc use, using Resource Booker.

CAPACITY

**1 VENUE
60 PEOPLE**

AVAILABILITY

Available for timetabled classes and ad-hoc bookings via Resource Booker.

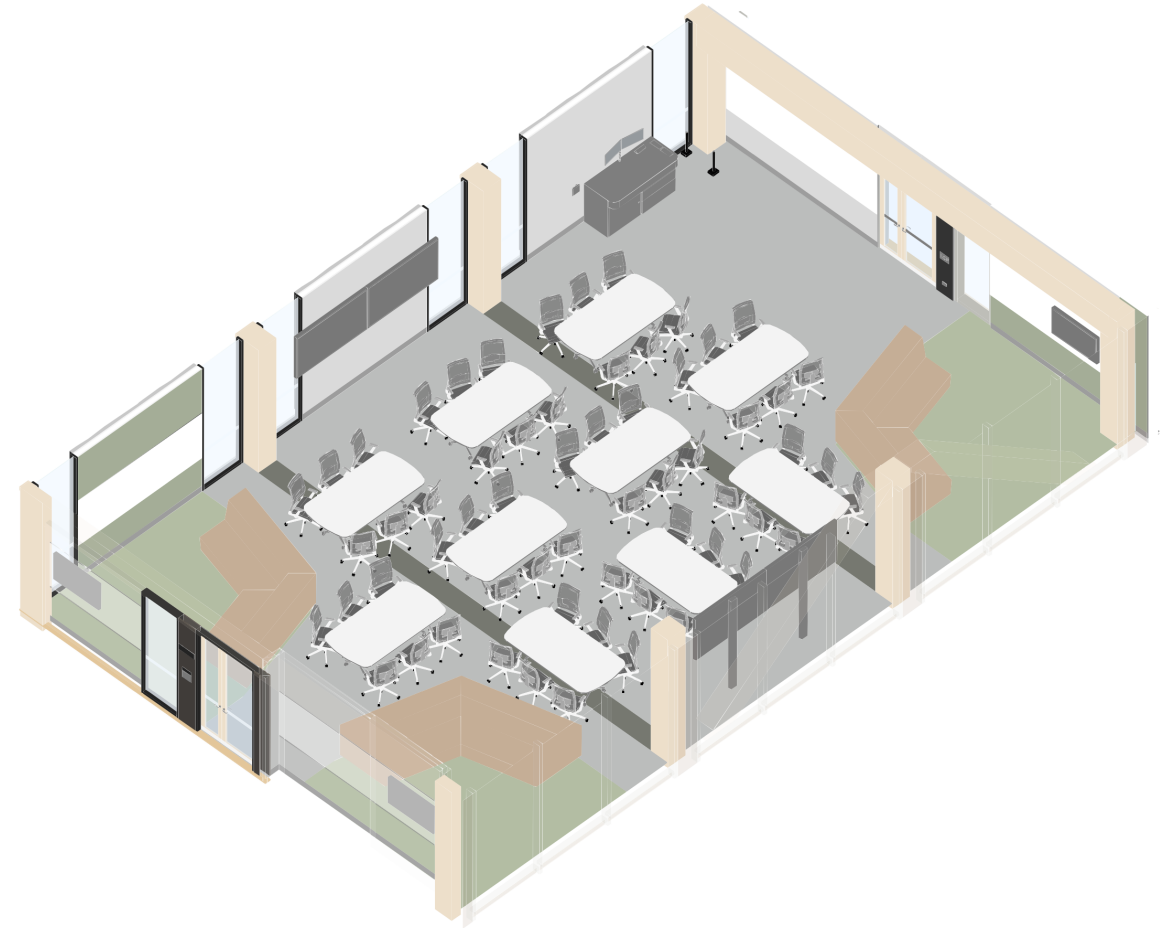

Technology-Enhanced Learning (TEL)

Equipped with the latest in audio-visual and virtual collaboration tools, the Technology-Enabled Learning (TEL) spaces offer opportunities to *enhance* learning by connecting physical and virtual participants in active engagement.

The features in these spaces also support the creation of learning environments that bring your remote students into the classroom to participate in learning activities and collaborate with their in-person peers.

The TEL desk spaces allow for individual and group learning activities to be easily shared across screens, while embedded microphones and tracking cameras facilitate ease of access for all learners, whether they are contributing from the physical or virtual classroom environment.

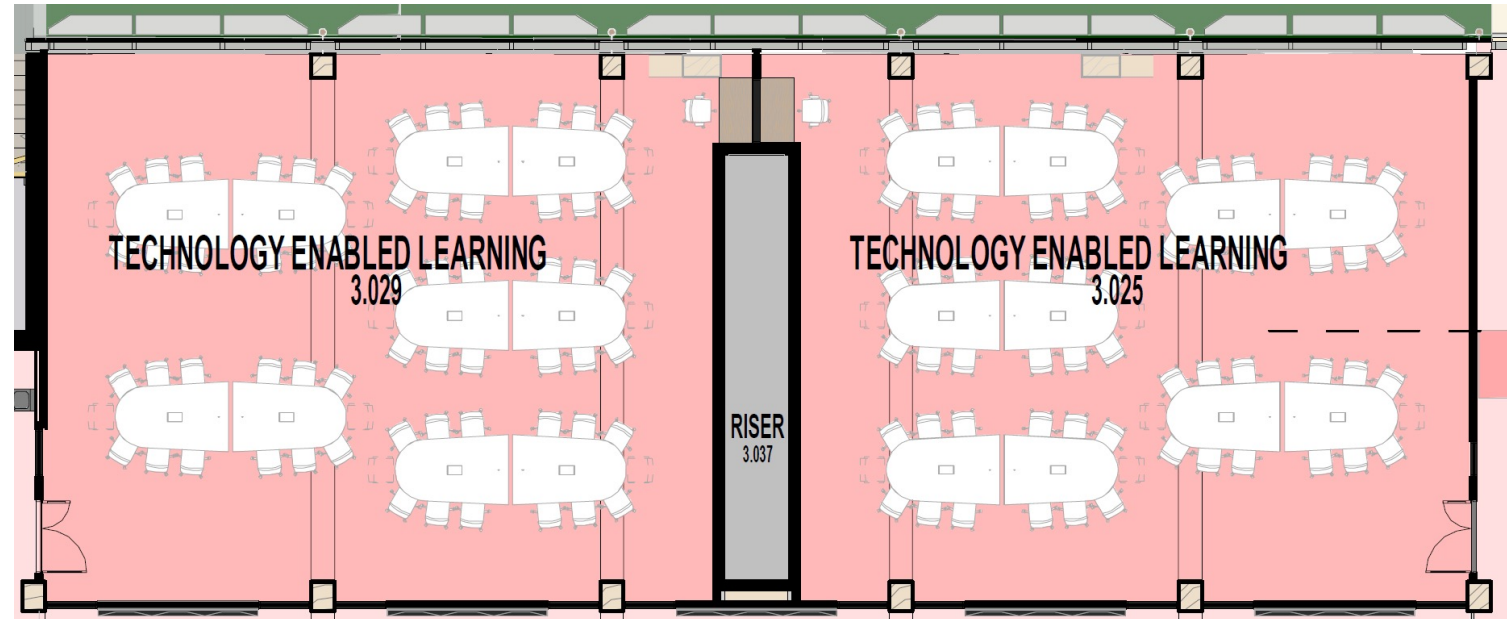

CAPACITY

2 VENUES
60 PEOPLE (EACH)

AVAILABILITY

Available for timetabled classes and ad-hoc bookings via Resource Booker.

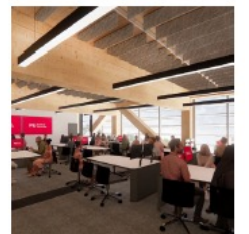

Scan for a 3D walk-through of a Technology-Enhanced Learning Space on Level 2 and Level 3

Innovation Hub

The Innovation Hub is a learning space intended for Murdoch Staff participation in workshops and seminars, functions, collaboration with industry partners and professional development initiatives.

The room is furnished with flip-top tables and nesting chairs, enabling flexibility in layout and configuration.

The Flexible Staff Workplaces on Level 2 and Level 3 are staff and approved visitor secured work areas intended for casual use. They offer hot-desks with power, monitors & docking stations, printing, kitchenette facilities, small meeting rooms and collaboration areas and lockers for day-use.

The Innovation Hub and the Workplace are not suitable for student engagements.

CAPACITY

1 VENUE
56 STAFF

AVAILABILITY

The Innovation Hub can be booked for staff and industry events via Resource Booker.



Illustration shows the Flexible Staff Workplace drop-in tables for short-term visits.

Level 4

Upon reaching Level 4, you will be greeted by the Student Hall, which features small group working desks along the western facade and leads to the Student Portal Deck outside.

This is where our largest learning spaces reside. Along the southern end, the collaborative learning space has spectacular views towards Beelihar Wetlands.

The Collaborative Learning spaces can be reconfigured for events, offering a commanding and noteworthy space for your function, engagement or showcase.

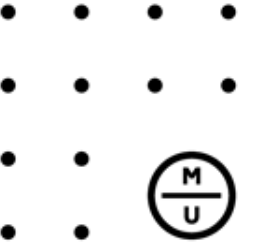
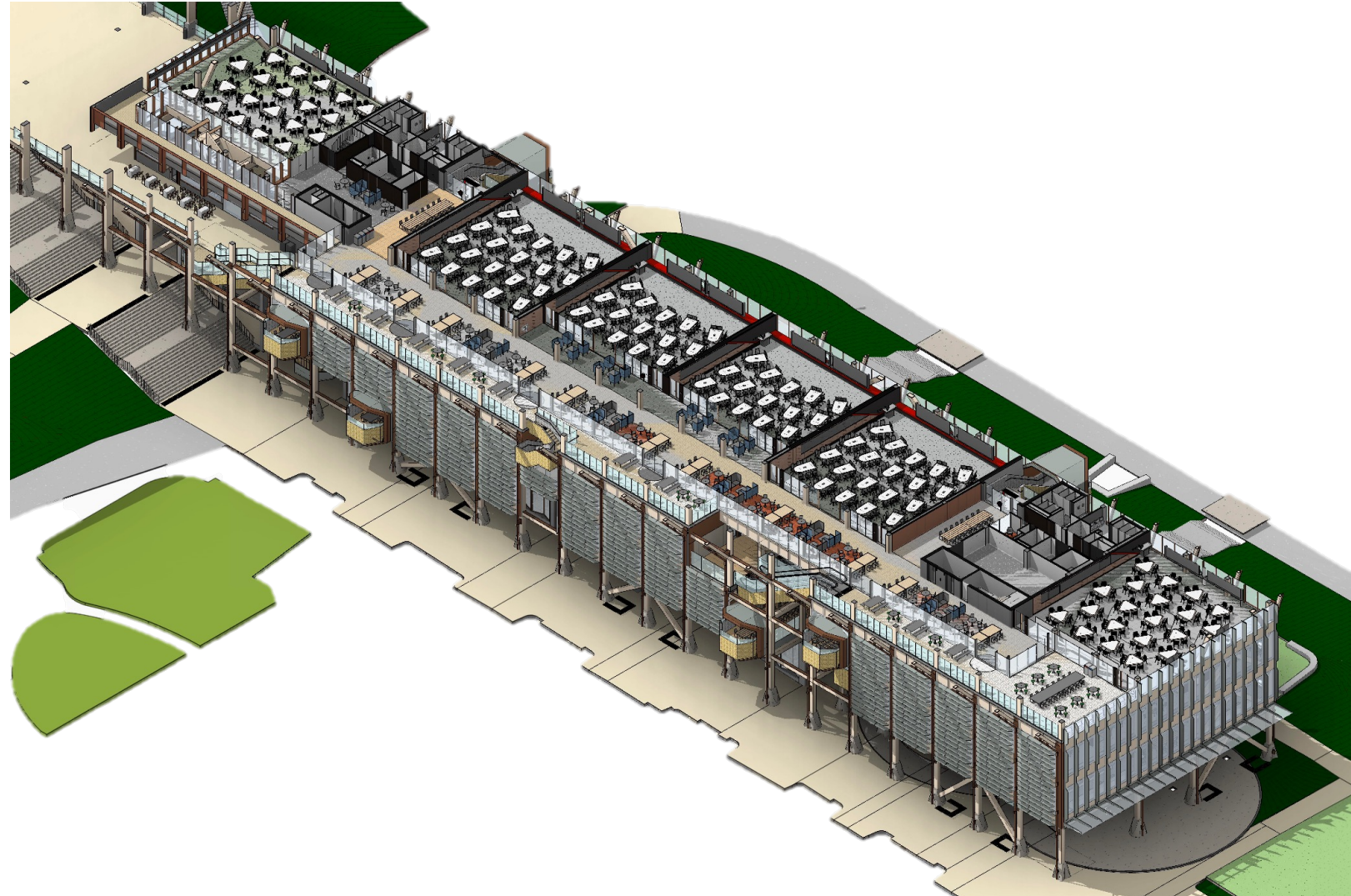

Collaborative Learning

Collaborative Learning spaces offer flexibility, with movable furniture that enables you to easily transition learners from independent to small or even large group learning activities.

Collaborative Learning spaces feature multiple large whiteboards and digital displays that allow for you and your students to mirror screens, share workings on the whiteboards, and engage in a variety of presentation opportunities.

Both spaces can be reconfigured for events or cleared entirely through the purpose designed movable furniture.

Events provisions have also been built into these rooms, with underfloor cable containment usable for professional AV bump-in services.

CAPACITY

2 VENUES
120 PEOPLE (EACH)

AVAILABILITY

Available for timetabled classes and ad-hoc bookings via Resource Booker.

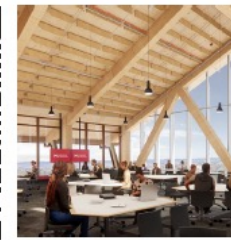
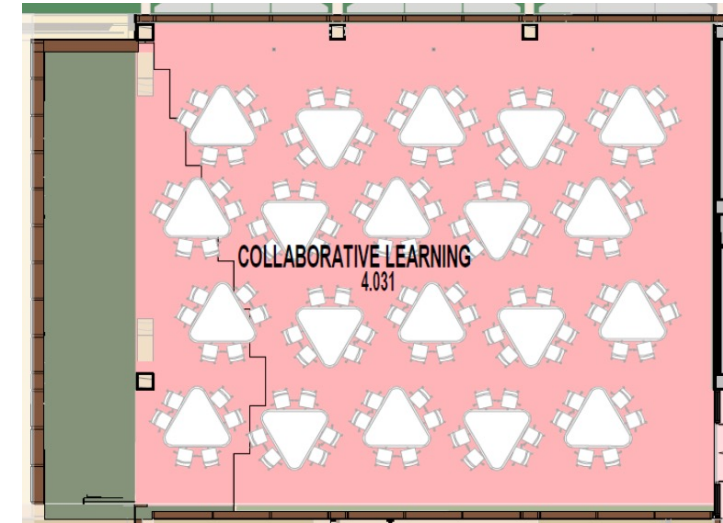
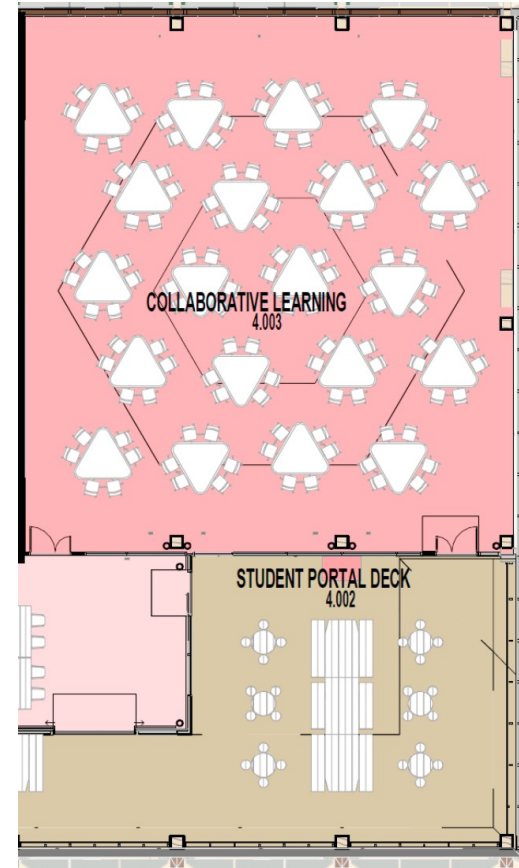

Scan for a 3D walk-through of the Collaborative Learning Space on Level 4

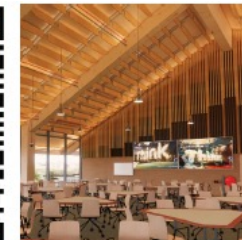

Scan for a 3D walk-through of the Collaborative Learning Space on Level 4

Tiered Technology-Enhanced Learning

The Tiered Technology-Enabled Learning spaces on Level 4 feature fixed TEL desks arranged on a gentle tier that promote sight lines across the venue, as well as ease of accessibility, to offer an *enhanced* learning experience.

These large learning spaces feature multiple digital displays that enable you, your teaching team, and your students to mirror screens, collaborate on activities and share with one another through a variety of presentation opportunities.

The TEL desk spaces allow for small and large group learning activities to be easily shared across screens, while embedded microphones and tracking cameras facilitate ease of access for all learners, whether they are contributing from the physical or virtual classroom environment. Equipped with the latest in audio-visual and virtual collaboration tools, the Tiered Technology-Enhanced Learning support the creation of team-taught learning environments that can easily bring your remote students into the classroom to participate in learning activities and collaborate with their in-person peers.

CAPACITY

2 VENUES
120 PEOPLE (EACH)

2 VENUES
90 PEOPLE (EACH)

AVAILABILITY

Available for timetabled classes and ad-hoc bookings via Resource Booker.

Scan for a 3D walk-through of the Tiered TEL Space on Level 4

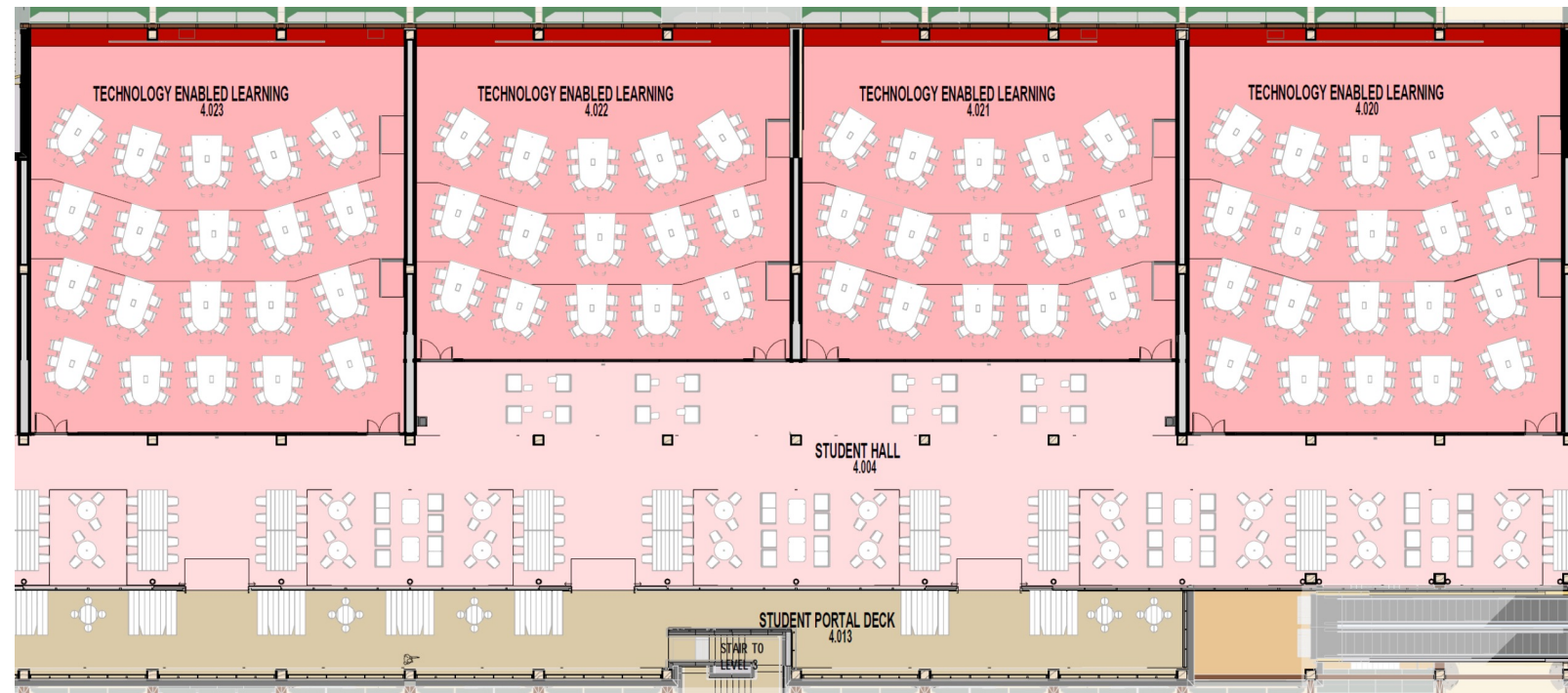
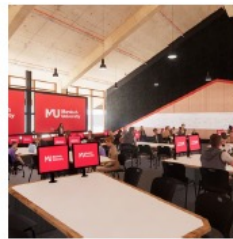

2

Room Amenities



Learning Space Design and Amenity

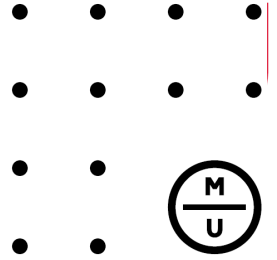

PODIUM

Each learning space features a Podium where you can connect your laptop, device, or present files from a USB stick. Your timetabled class will automatically have a Teams meeting available to start with one click from the console.

The Podium includes Dell Optiplex 7000 PC, along with an easy-to-use dual touch-screen audio-visual (AV) control panel and a Crestron panel that connects to your Microsoft Teams Room (MTR device). You can access your teaching materials by connecting your devices to Airmidia or use a USB. You will also find a moveable Lectern. The Tablet device and microphones here are in the top locked drawer and secured by Cardax.

MICROPHONE

At the podium, you will find **lapel mics** and **hand-held microphones**. Microphones are installed on each TEL space desk and portable microphones can be placed on Collaborative Learning space tables.

TABLET

Collaborative and Technology-Enabled Learning spaces are equipped with a Dell Latitude Tablet PC that duplicates the AV controls, allowing you to manage all cameras, microphones, AV technology and Microsoft Teams while being mobile around your classroom.

These tablet hardware specifications are well suited to managing the digital experience and include a camera allowing you to connect to the remote classroom and show close-up of class materials, such as an artefact at a student desk.

WIFI

Building 360 Boola Katitjin features high bandwidth wireless internet. Staff and students can connect to *Eduroam* and guests can connect to the *Guest Eduroam* network.

CAMERAS

A movement-tracking camera captures you as you walk around the learning space, allowing remote participants to see and hear the classroom engagement and improve the sense of connection and belonging.

Cameras can be reset by clicking the reset button at on the podium display screens, which will redirect the camera to the starting position at the podium.

WHITEBOARDS

Whiteboards around each room provide flexibility for teaching and collaboration. Pressing a button under the whiteboards also activates a camera that captures and shares the content written there to the room's large screens for ease of visibility, as well as for those attending virtually.

Learning Space Design and Amenity

MAIN DISPLAY SCREENS

Learning Spaces are fitted with high-resolution 4K large format LCDs as the main display screen. When you share through the Podium, your device, or tablet, your content will display on these screens. The touch panels on the Podium enable you to control what is presented. Large rooms on Level 4 also have 'video walls' comprised of 18 display screens.

ENTRY PANEL

Every room features a Booking Panel beside the entrance, that indicates current and upcoming bookings. When a Meeting or Project room is vacant, a student or staff member can book that room for ad-hoc use.

LIGHTING

Learning Spaces feature LED Linear Lighting, identical to the lights in the Pilot space.

Spaces in Boola Katitjin are equipped with motion sensor lighting. When you enter a room, your movement will be automatically detected, and the lights will turn on.

Lighting can be adjusted on the touch panel at the Podium, where functionality to control brightness / dimming is available.

WINDOW TREATMENTS

Electronic blinds will be controlled via a button on the Podium touch panel. You can also contact Building & Maintenance Services should the blinds require adjustment.

ACOUSTIC TREATMENTS

Acoustic treatments are used to manage the quality of sound in a space. Throughout Boola Katitjin, treatments are tailored to the needs of the learning space and include:

- Acoustic glazing and partitions
- Acoustic separation between floors, achieved through floor linings, baffle and carpets.
- Acoustic treatments applied to walls and ceilings, and inherent to the building design.

Pictured below – sound absorption panels can be seen lining the roof of the learning space.



POWER POINTS

Student desks in the Technology-Enabled Learning spaces are equipped with power points. This allows students to bring their own device and plugin at the desk.

Collaborative Learning spaces have a flexible design, with tables reconfigurable to serve a variety of purposes. Students can ensure their device has power by using one of the charging stations in the Student Hall. Power Points are included on the Podium, so Facilitators can bring their own device and remain fully charged throughout their presentation.

ACCESSIBILITY

Collaborative and Technology-Enabled spaces include Williams IR hearing augmentation. A movable height desk is available in every space.

WASTE MANAGEMENT

Sustainable waste management has been carefully considered in the design of the building and is reflected in the operational waste management plan.

In promoting sustainable behaviour, it is intended that people take coffee cups, excess papers and recyclables out of learning spaces and meeting rooms, and deposit into the appropriate centrally located general waste & recyclable bin stations on that floor, which will be serviced daily by cleaners.

Summary of technology in learning spaces

The following two pages provides a summary of technology in the learning spaces outlined in this guide.

ROOM NUMBERING

In Boola Katitjin, spaces, meeting rooms, student collaboration areas, retail outlets and maintenance areas are all numbered counting 001 from the southern end at Discovery Way, to the northern end at the boardwalk.

WAYFINDING

Murdoch Maps will provide detailed wayfinding through Boola Katitjin. Room numbering and signage will be obvious, and touch-screens will enable visitors to locate a venue.

Three digital touch-screens for wayfinding are located at

- The Southern Lawn, off Discovery Way between Boola Katitjin and IID.
- Arrival Hall on Level 1 – Discovery Way
- Student Centre on Level 3 - Boardwalk

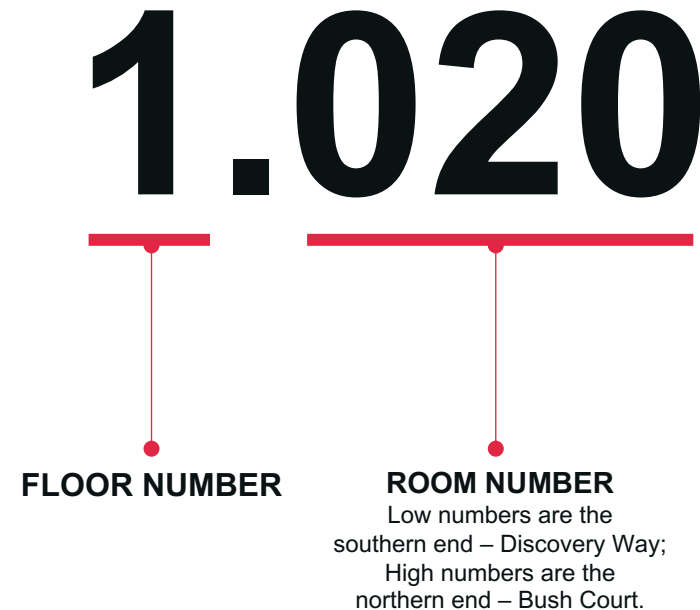

Room Number	Name	Capacity	Teaching Mode	Layout	Activity Type	Presentation	Document Camera	Whiteboard	Participant Desk PC	Participant Microphone	Power Points	Large Display Screens
LEVEL 1												
1.001	Welcome Space	70-220	Seminar Presentation	Amphitheatre	Event	AirMedia Move-In AV Podium	-	-	-	-	-	17-Channel Digital Ribbon
1.010	Digital Immersive Lab	40	Teacher Led Group Work	Fixed Tables Open	Timetabled Ad-Hoc	AV Podium Tablet / MTR	-	-	Yes	-	-	4 + Video Wall
1.011	Creative Workshop Space	56	Teacher Led Group Led Group Work	Flex Tables Fixed Booths Open	Ad-Hoc	AirMedia Central AV Podium	-	-	-	-	At Desk	2
1.012	Laptop Lounge	56	-	Fixed Tables Fixed Bench	Self-Directed	AirMedia	-	-	-	-	At Desk	-
1.013	Computer Lab 1	60	Teacher Led Individual Work	Fixed Desks	Timetabled Ad-Hoc	AV Podium	-	Yes	Yes	-	At Desk	Video Wall
1.014	Computer Lab 2	60	Teacher Led Individual Work	Fixed Desks	Timetabled Ad-Hoc	AV Podium	-	Yes	Yes	-	At Desk	Video Wall
LEVEL 2												
2.020	Technology-Enabled Learning	60	Teacher Led Group Work Group Led Individual Work	10 6-pax TEL Desks	Timetabled Ad-Hoc Teaching	Lectern AV Podium Tablet / MTR	Yes	Yes	Yes	Fixed at Desk	At Desk	4
2.023	Collaborative Learning	90	Teacher Led Group Work Group Led Individual Work	15 6-pax Flex Tables	Timetabled Ad-Hoc Teaching	Lectern AV Podium Tablet / MTR	Yes	Yes	-	Flex placed on Table	-	8
2.025	Collaborative Learning	60	Teacher Led Group Work Group Led Individual Work	10 6-pax Flex Tables	Timetabled Ad-Hoc Teaching	Lectern AV Podium Tablet / MTR	Yes	Yes	-	Flex placed on Table	-	4
2.024	Technology-Enabled Learning	60	Teacher Led Group Work Group Led Individual Work	10 6-pax TEL Desks	Timetabled Ad-Hoc Teaching	Lectern AV Podium Tablet / MTR	Yes	Yes	Yes	Fixed at Desk	At Desk	4
2.027	Collaborative Learning	60	Teacher Led Group Work Group Led Individual Work	10 6-pax Flex Tables	Timetabled Ad-Hoc Teaching	Lectern AV Podium Tablet / MTR	Yes	Yes	-	Flex placed on Table	-	4

Room Number	Name	Capacity	Teaching Mode	Layout	Activity Type	AV Controls	Document Camera	Whiteboard	Participant Desk PC	Participant Microphone	Power Points	Large Display Screens
LEVEL 3												
3.002	Innovation Hub - Staff	60-170	N/A	Flex Tables and Chairs	Seminar Workshop Event	Airmedia	-	-	-	Yes	-	2
3.025	Technology-Enabled Learning	60	Teacher Led Group Work Group Led Individual Work	10 6-pax TEL Desk	Timetabled Ad-Hoc Teaching	Lectern AV Podium Tablet / MTR	Yes	Yes	Yes	Fixed at Desk	At Desk	4
3.028	Collaborative Learning - Breakout	60	Teacher Led Group Work Group Led Individual Work	3 Breakout Corners 10 6-pax Flex Table	Timetabled Ad-Hoc Teaching	Lectern AV Podium Tablet / MTR	Yes	Yes	-	Flex placed on Table	-	7
3.030	Technology-Enabled Learning	60	Teacher Led Group Work Group Led Individual Work	10 6-pax TEL Desk	Timetabled Ad-Hoc Teaching	Lectern AV Podium Tablet / MTR	Yes	Yes	Yes	Fixed at Desk	At Desk	4
3.032	Collaborative Learning	90	Teacher Led Group Work Group Led Individual Work	15 6-pax Flex Table	Timetabled Ad-Hoc Teaching	Lectern AV Podium Tablet / MTR	Yes	Yes	-	Flex placed on Table	-	8
3.034	Collaborative Learning	60	Teacher Led Group Work Group Led Individual Work	10 6-pax Flex Tables	Timetabled	Lectern AV Podium Tablet / MTR	Yes	Yes	-	Flex placed on Table	-	4
3.040	Northern Plaza	500	N/A	Open	Event	AirMedia Move-In AV Podium	-	-	-	-	Yes	2

Key to the Summary Table

- **Room number, Name and Capacity** advise what type of learning space that room provides, and how many seats are available.
- **Teaching Mode** provides at-a-glance the type of learning delivery best suits the space.
- **Layout and Activity Type** indicate how desks, tables and seating is arranged and provides at-a-glance on the activities and prioritised use of the space.
- **Presentation** refers to the resources available to manage delivery, screens and audio. MTR refers to the Microsoft Teams Room device.
- **Document Camera, Whiteboard, Participant Desk PC, Participant Microphone and Power Points** refer to the equipment provided for content delivery separate to the Podium, and typically refer to equipment at student desks.
- **Large Display Screens** indicates the number of large, wall-mounted display screens installed in the space.

Room Number	Name	Capacity	Teaching Mode	Layout	Activity Type	AV Controls	Document Camera	Whiteboard	Participant Desk PC	Participant Microphone	Power Points	Large Display Screens
LEVEL 4												
4.003	Collaborative Learning	120	Teacher Led Group Work Group Led Individual Work	20 6-pax Flex Tables	Timetabled Events	Lectern AV Podium Tablet / MTR	Yes	Yes	-	Flex placed on Table	-	4 + Video Wall
4.020	Technology-Enabled Learning	120	Teacher Led Group Work Group Led Individual Work	20 6-pax TEL Desk	Timetabled Ad-Hoc Teaching	Lectern AV Podium Tablet / MTR	Yes	Yes	Yes	Fixed at Desk	At Desk	Video Wall
4.021	Technology-Enabled Learning	90	Teacher Led Group Work Group Led Individual Work	15 6-pax TEL Desk	Timetabled Ad-Hoc Teaching	Lectern AV Podium Tablet / MTR	Yes	Yes	Yes	Fixed at Desk	At Desk	Video Wall
4.022	Technology-Enabled Learning	90	Teacher Led Group Work Group Led Individual Work	15 6-pax TEL Desk	Timetabled Ad-Hoc Teaching	Lectern AV Podium Tablet /MTR	Yes	Yes	Yes	Fixed at Desk	At Desk	Video Wall
4.023	Technology-Enabled Learning	120	Teacher Led Group Work Group Led Individual Work	20 6-pax TEL Desk	Timetabled Ad-Hoc Teaching	Lectern AV Podium Tablet/ MTR	Yes	Yes	Yes	Fixed at Desk	At Desk	Video Wall
4.031	Collaborative Learning	120	Teacher Led Group Work Group Led Individual Work	20 6-pax Flex Tables	Timetabled Events	Lectern AV Podium Tablet / MTR	Yes	Yes	-	Flex placed on Table	-	4 + Video Wall

Technology-Enabled and Technology-Enhanced

Boola Katitjin has been designed with spaces that enhance learning through the inclusion of innovative technologies and technology implementations, including the TEL desks. The learning spaces are known as Technology-Enabled Learning Spaces, which is the formal name given to such spaces from the Tertiary Education Facilities Management Association (TEFMA) and is the name we report space utilisation against. This is the name referred to on floor plans, wayfinding and in Resource Booker.

Teaching in a TEL Space is considered the activity of Technology-Enhanced Learning. The Tertiary Education Quality and Standards Agency (TEQSA) interprets TEL as electronic and computer-based communications technologies combined with pedagogical principles and practices that are applied to and tailored for delivery, which ranges from augmented face-to-face teaching from limited, to blended delivery, to fully online delivery. *(TEQSA Guidance note: Technology-enhanced learning, V1.2).*

In Boola Katitjin, we refer to the spaces as Technology-Enabled and to practice as Technology-Enhanced. The acronym, TEL, can refer to both interchangeably.

3

Spaces for Student Learning



Laptop Lounge

The Laptop Lounge is a space where students can prepare for digital learning experiences or presentations. It is located beside the Computer Lab on Level 1.

Designed for collaborative and individual work, the Lounge allows students to walk up and create an ad-hoc booking for the room, using the Room Booking Panel.

Students can book the space for exclusive use by their group or class. Alternatively, they can use it ad-hoc in conjunction with other students conducting similar preparation or collaboration.

LOCATION

- Level 1, beside the Computer Lab

AVAILABILITY

Bookable for ad-hoc use using booking screens located outside the room.

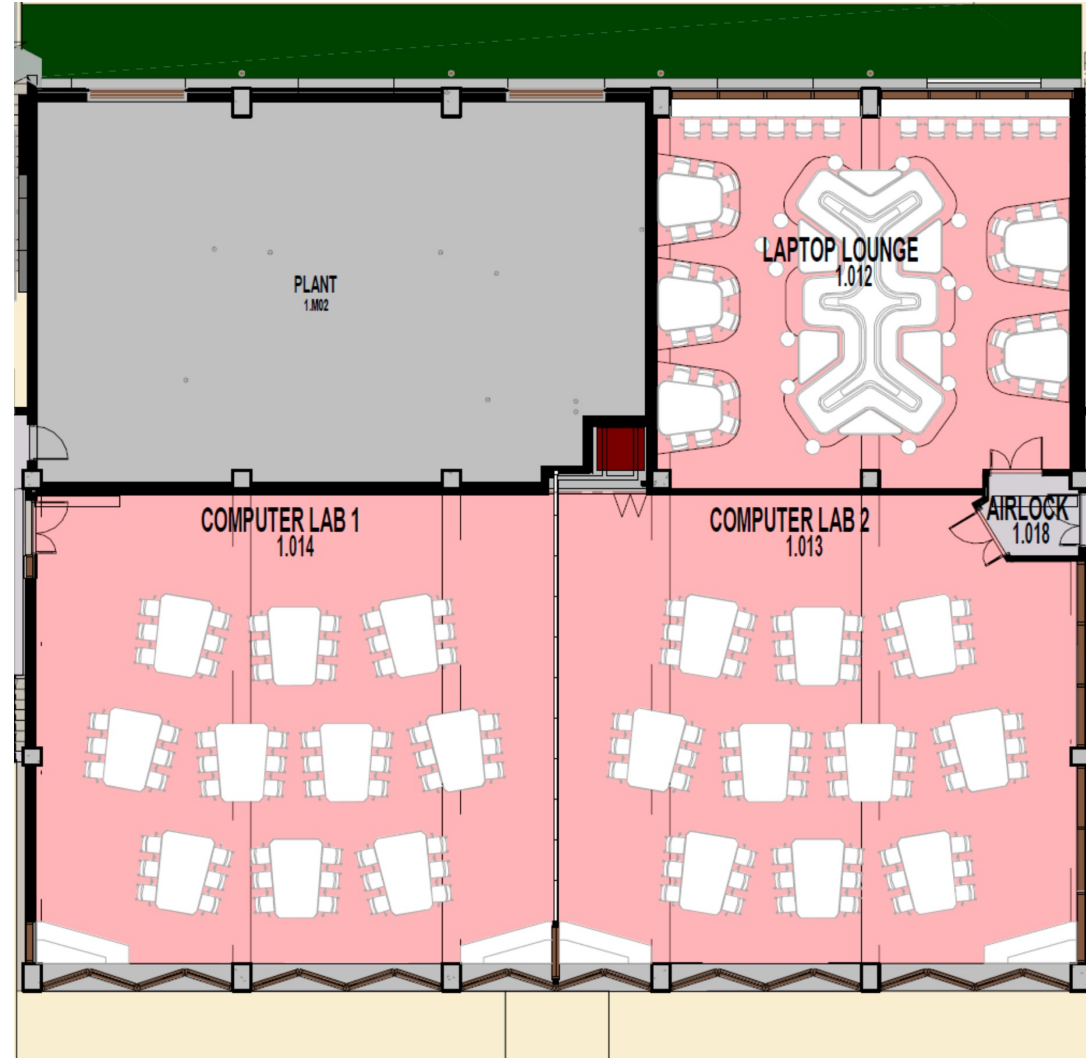

Project Rooms

Project Rooms are private spaces that students can book to work in collaboration with up to 4 peers in-person or with remote collaborators.

Each room is equipped a Microsoft Teams Collaboration Panel that allows students to initiate Teams meetings with remote peers.

Airmedia enables students to connect a personal device to the high-resolution large format LCD screens, to project group work, collaborate on digital artefacts, and share their screen with remote participants.

LOCATION

- 12 Project Rooms are available on Level 2
- 2 Project Rooms are available on Level 3

AVAILABILITY

Bookable for ad-hoc use using booking screens located outside the room or via Outlook.

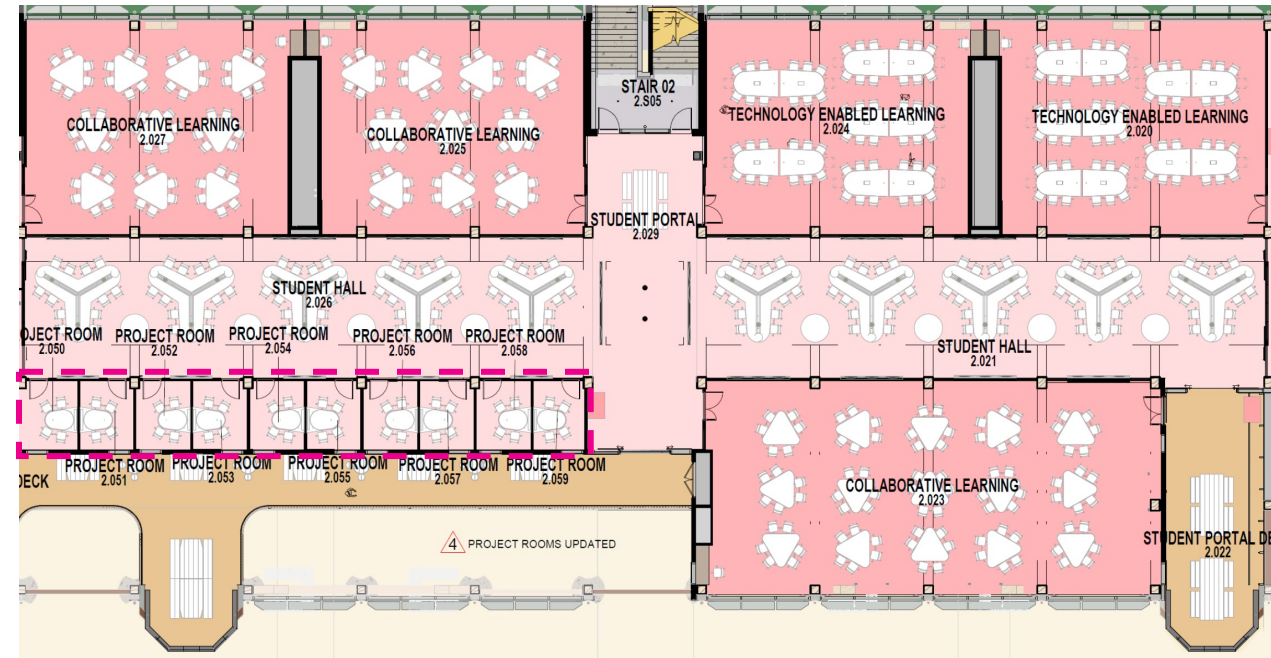
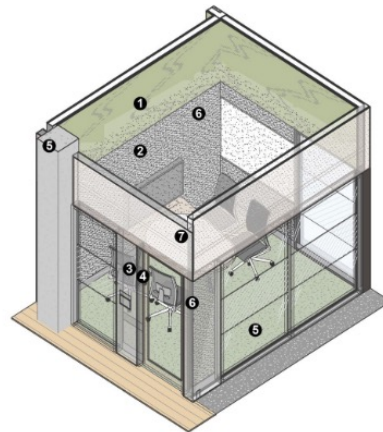

Student Hall and Portal

Hallways between learning spaces feature spacious tables for collaboration, movable seating, and whiteboards for students to work through ideas, problems and projects.

On Level 4, the Student Hall will feature lounge and flexible seating along the window, looking over the Student Portal Deck towards Banksia Court.

The Student Portal runs east to west, inside and onto the deck, on Levels 2 and 3. Student kitchen facilities are located on Levels 2 and 3



Scan for a 3D walk-throughs of the Student Halls on Level 3 (above) and Level 4 (below)



Scan for a 3D walk-through of the Student Portal

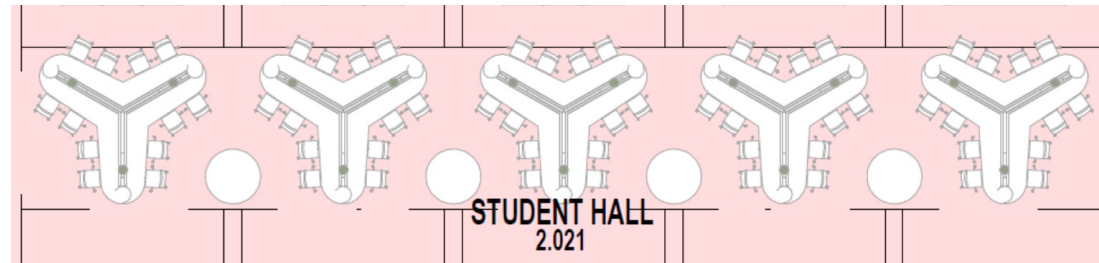
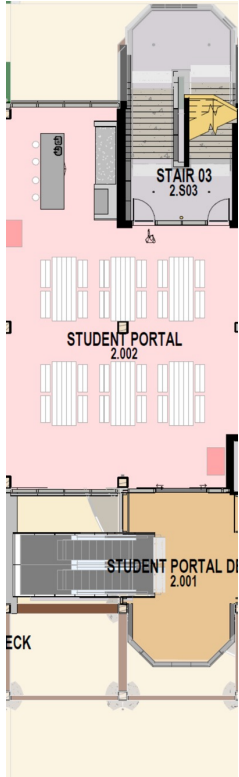
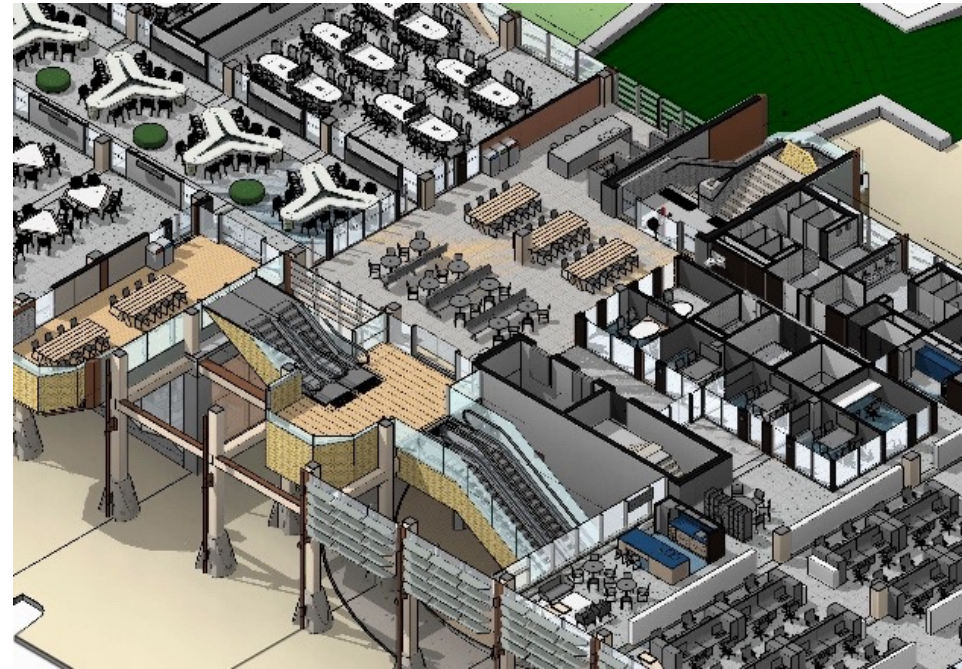

4

Floor Plans and Further Information



Level 1

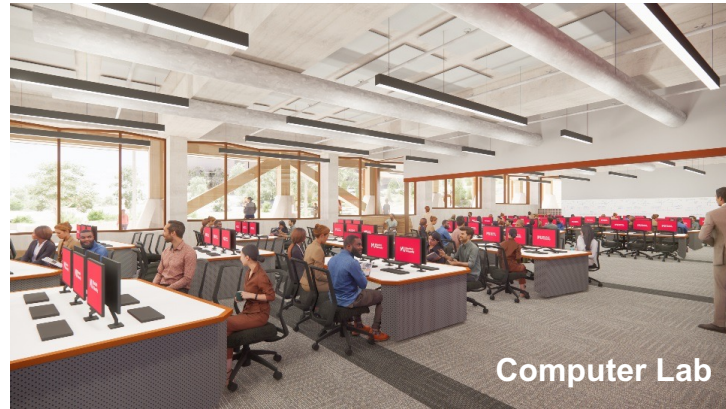

Level 2

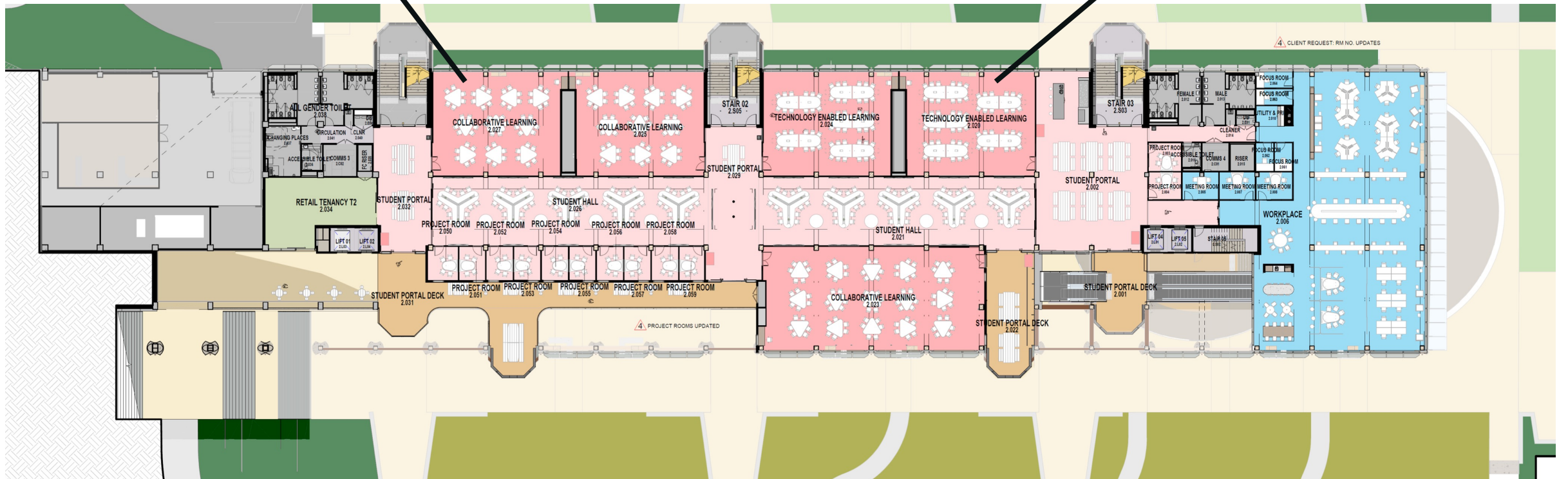
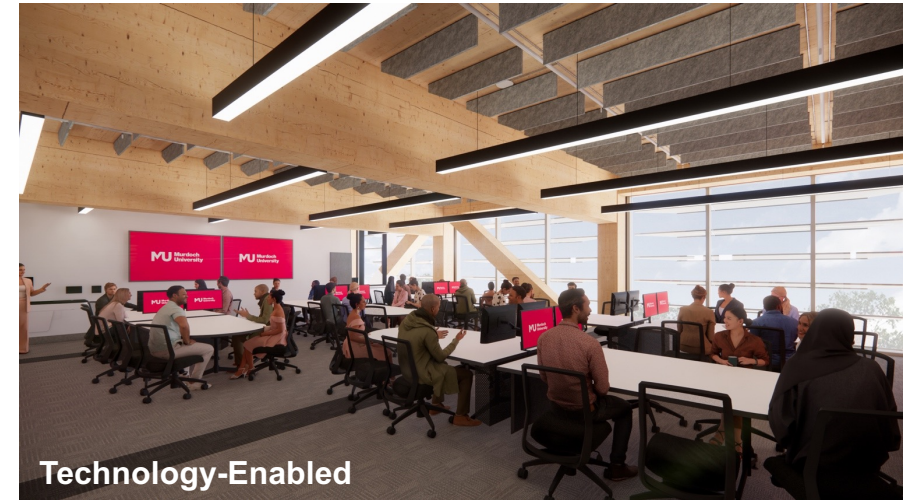

Level 3

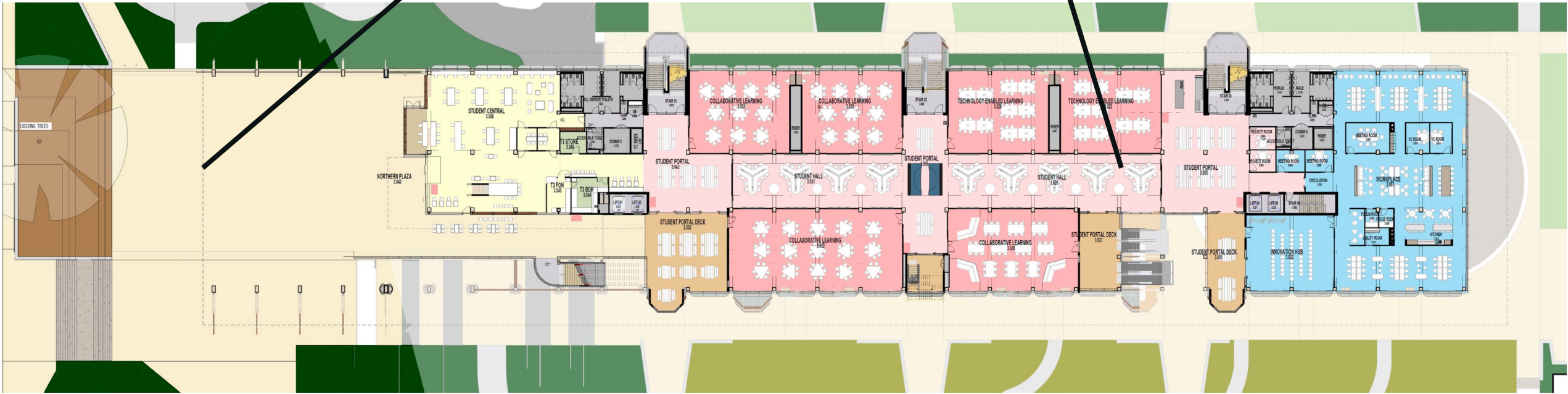

Level 4

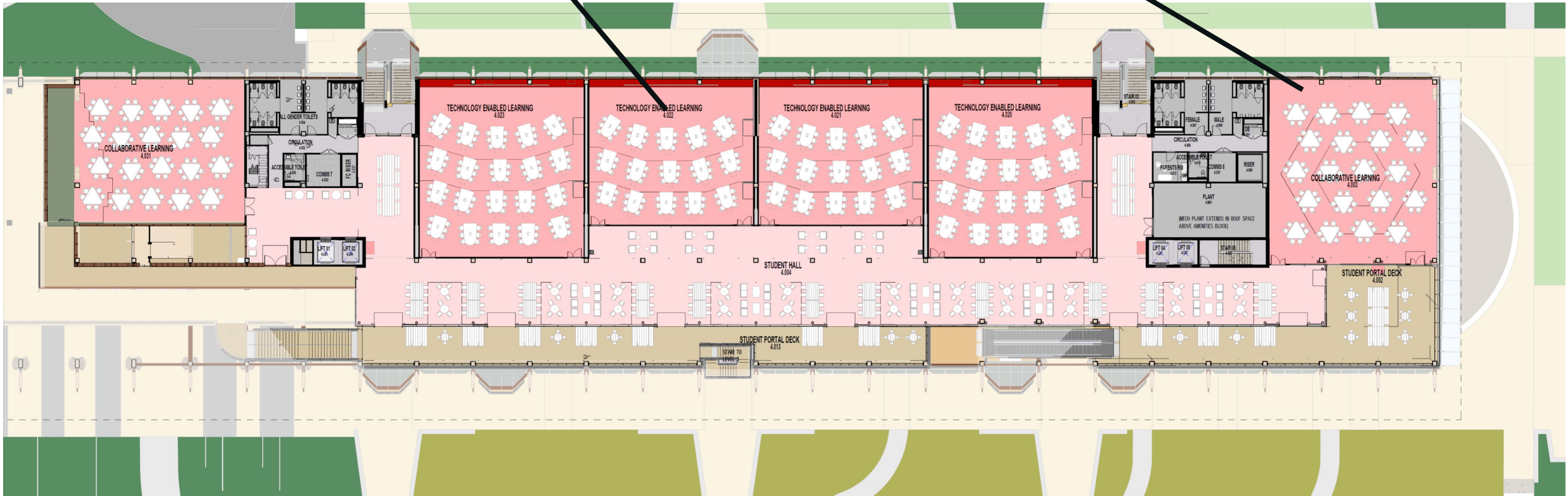

Further Information

SUPPORT FOR TEACHING IN SEMESTER 1, 2023

Staff who have been allocated to Boola Katitjin venues for Semester 1, 2023 will be supported, with:

- Teaching in Boola Katitjin pages on the Intranet, which includes self-learning resources on the learning spaces and technologies, such as this guide.
- Discovering Teaching in Boola Katitjin Orientation Module on LMS, that provides pedagogical and technological guidance to the learning spaces.
- The Professional Learning team has been engaging with Schools and Disciplines to provide information sessions and workshops that addresses your teaching needs.
- IT Audio-Visual Support have recruited additional team members, to provide additional support provisions for your use of the AV technology

[Visit TCMS to enroll in professional learning events](#)

Coming in January 2023:

- **Guide to Boola Katitjin**, A detailed guide covering teaching, learning and working in Boola Katitjin is being prepared, and will be included on the Murdoch website. It will launch ahead of the building opening and provide comprehensive information for staff, students and visitors.
- **Teaching in Boola Katitjin** intranet site
- **Discovering Teaching in Boola Katitjin** Orientation Module in LMS

BOOKING SPACES FOR EVENTS AND ACTIVITIES

The spaces noted in this guide are available for timetabled activities, ad-hoc teaching, meetings or for events.

Building 360 Boola Katitjin can be booked like any venue on campus, with formal learning and teaching venues only able to be made after publication of University timetables.

The new **Resource Booker** system makes it easy to identify whether the space you would like to book is available. It then enables hosts to enter all information needed by Room Bookings and Facilities Management Services to assess your request and identify where applicable support is needed.

In some instances, bookings may not be approved, require more information or costs may be incurred as is standard for all space bookings across campus (for example, cleaning costs).

Boola Katitjin spaces will be available for booking from Nov 14, 2022 for dates occurring after February 27, 2023.

➤ [Visit Resource Booker](#)

STORAGE AND SECURITY

No secure storage for teaching materials are available in Building 360 Boola Katitjin. It is recommended that Academic staff work with technical services and support staff for the transport of any materials required for demonstration to and from the classroom. There is no provision for storage between classes.

Boola Katitjin is designed to operate 24/7, however, initially the building will function in two distinct modes:

- **BAU:** full access during typical business hours Monday – Friday 7am to 5.30pm
- **Afterhours:** access to various spaces on Levels 1 & 2 from 5:30pm – 12am. After which time, students will be redirected to the 24/7 Library space.

Analysis will be undertaken throughout the year to confirm demand from student and staff for extended afterhours access. PDCSO operations will then respond accordingly.

A Murdoch issued Staff ID or Visitor ID card is required for access to the Flexible Staff Workspace and staff lockers. A Murdoch issued ID card is required to access and move through the building after 5:30pm.

Security cameras and help-points are present throughout and around the building respectively. Security team members will patrol the building after-hours at set intervals, as is standard for all Murdoch spaces. The [MurdochSafe app](#) is the easiest way to quickly access security and safety information.

Security can be contacted on 9360 6262 if required.

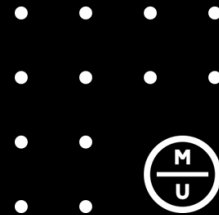

Thank you